

1.3. Final Planning Pack Drawings (Glanua)

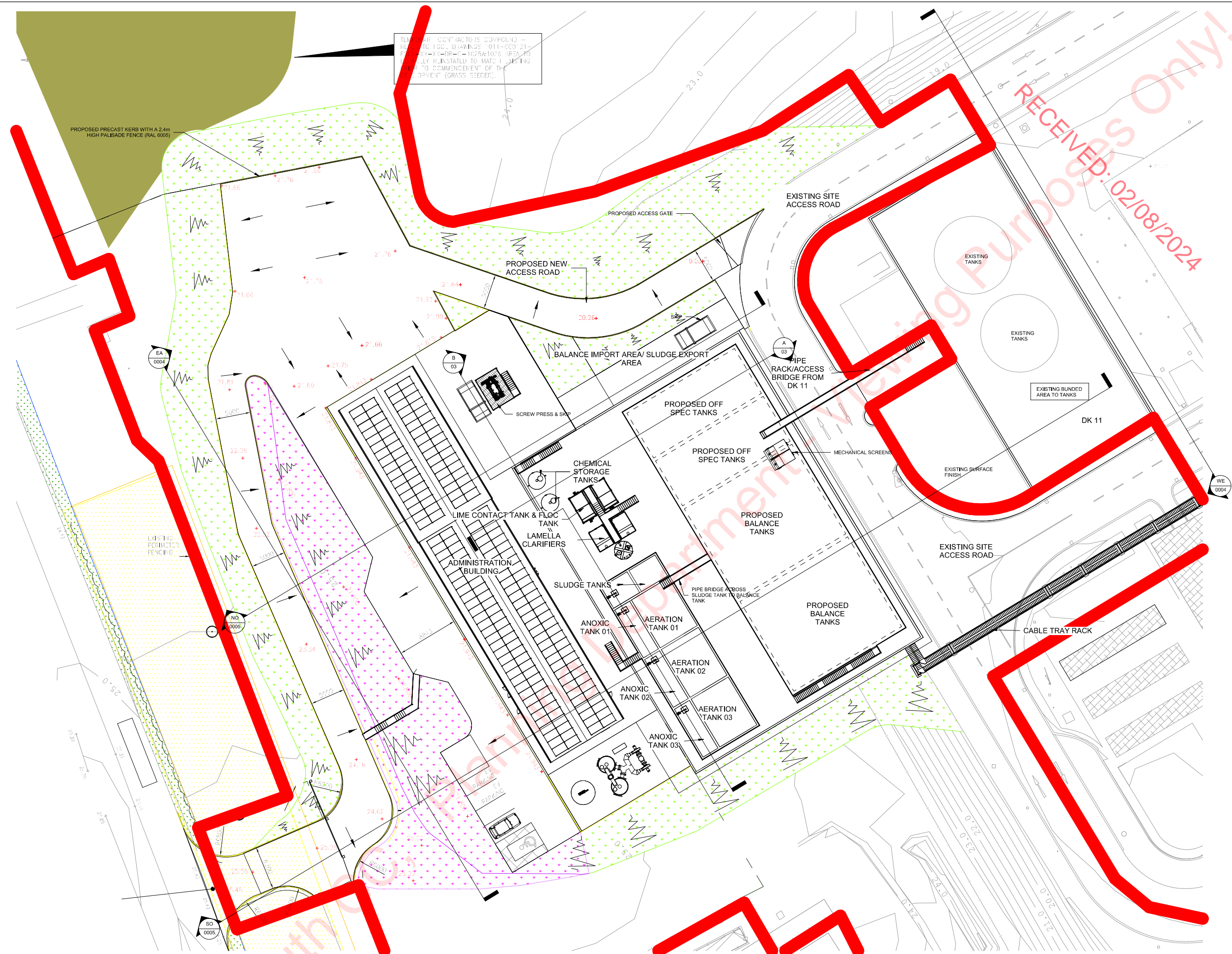



TEMPORARY CONTRACTORS COMPOUND - REFER TO FGCL DRAWINGS 1011-000121-M6-XX-XX-DR-M-1104 SITE ELEVATIONS 01
1011-000121-M6-XX-XX-DR-M-1105 SITE ELEVATIONS 02
AREA TO BE FULLY REINSTATED TO MATCH EXISTING PRIOR TO COMMENCEMENT OF THE DEVELOPMENT (GRASS SEEDING).

PROPOSED PRECAST KERB WITH A 2.4m
HIGH PALISADE FENCE (RAL 6005)

EA
0004

B
03

A
03

WE
0004

NO
0005

SO
0005

1 00_LVL SITE PLAN
1 : 250

NOTES

THIS DRAWING SHOULD BE READ IN CONJUNCTION WITH THE FOLLOWING
DRAWINGS:
1011-000121-M6-XX-XX-DR-M-1104 SITE ELEVATIONS 01
1011-000121-M6-XX-XX-DR-M-1105 SITE ELEVATIONS 02

The details provided will be subject to detailed design and agreed
with the Planning Authority in advance of construction, in the
event of a grant of permission

+6.84 - EXISTING LEVELS

+6.84 - PROPOSED LEVELS

SOFT LANDSCAPING TO EMBANKMENT- GRASS SEEDING

SOFT LANDSCAPING TO EMBANKMENT- GRASS SEEDING

SOFT LANDSCAPING TO EMBANKMENT- GRASS SEEDING

TEMPORARY CONTRACTORS COMPOUND - REFER TO FGCL DRAWINGS

1011-000121-FGCL-XX-XX-DR-C-1025&1026
AREA TO BE FULLY REINSTATED TO MATCH EXISTING
PRIOR TO COMMENCEMENT OF THE DEVELOPMENT
(GRASS SEEDING).

The details provided will be subject to detailed design and agreed with the Planning
Authority in advance of construction, in the event of a grant of permission.

| REV | DATE | DESCRIPTION | DRW | CHK | APP |
|-----|------------|--------------------------------|-----|-----|-----|
| P03 | 25/06/2024 | ISSUED FOR PLANNING PERMISSION | EO | MB | AH |

PLANNING STAGE

COPYRIGHT RESERVED - THIS DRAWING IS NOT TO BE USED FOR A
PURPOSE OTHER THAN THAT FOR WHICH IT HAS BEEN ISSUED BY
GLANUA LTD. NOR IS IT TO BE COPIED OR REPRODUCED IN
ANY MANNER WITHOUT WRITTEN CONSENT.

CLIENT

WuXi Biologics
Global Solution Provider

WuXi Biologics
Mulagharlin,
Dundalk,
Co. Louth, A91 X56F.

PROJECT

EFFLUENT BALANCING & RESOURCE
RECOVERY SYSTEM PROJECT

Glanua

Glanua Ltd.,
Railway House,
Station Road,
Loughrea,
Co. Galway,
IRELAND

Tel: +353 (0)909 630 301
Fax: +353 (0)909 630 300
e-mail: info@glanua.com
web: www.glanua.com

TITLE

GENERAL SITE LAYOUT

| SCALES | DRAWN | CHECKED | APPROVED |
|---------|-------|---------|----------|
| 1 : 250 | PH | MB | AH |

| DATE | DATE | DATE |
|------------|------------|------------|
| 25/06/2024 | 25/06/2024 | 25/06/2024 |

| DRAWING No. | STATUS | REVISION |
|--------------------------------|--------|----------|
| 1011-000121-M6-XX-XX-DR-M-1101 | S2 | P03 |

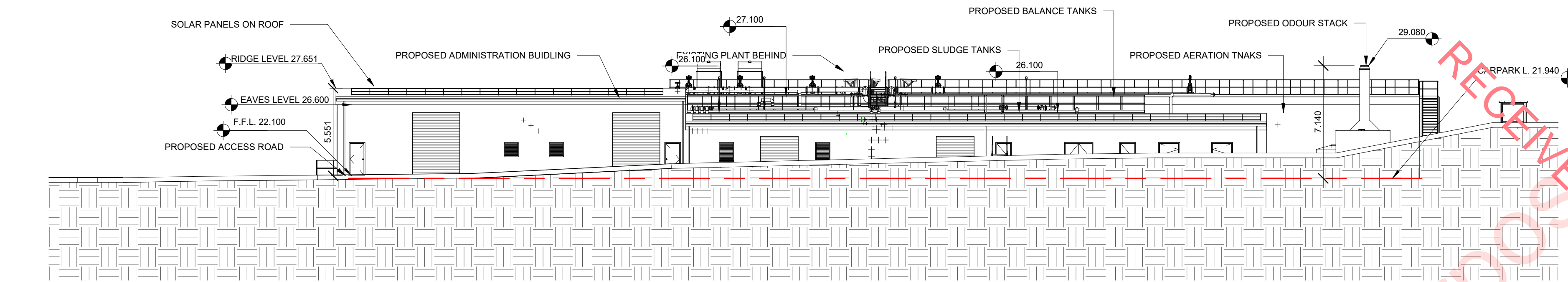

EA
EAST
1 : 200

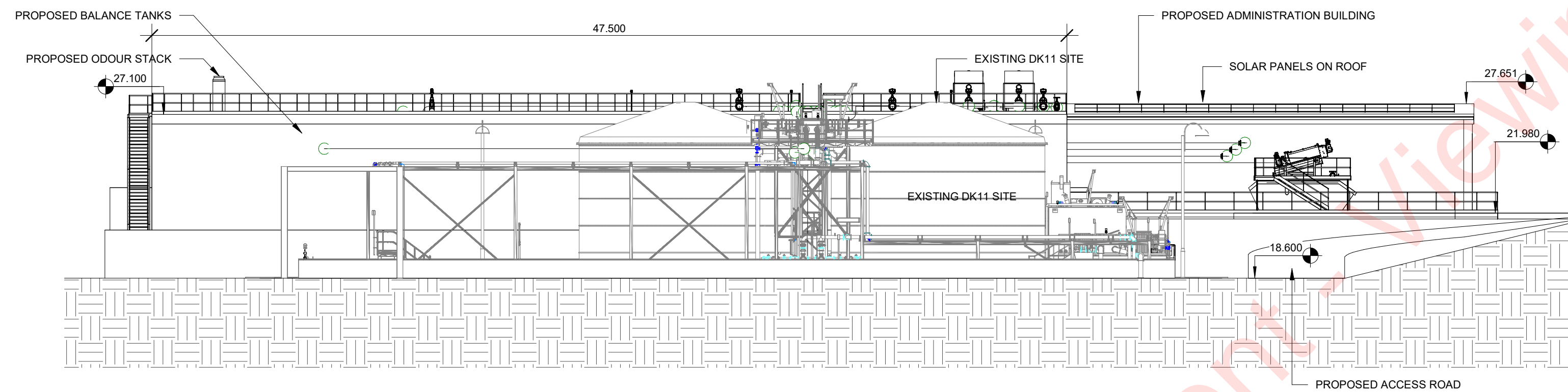

WE
WEST
1 : 200

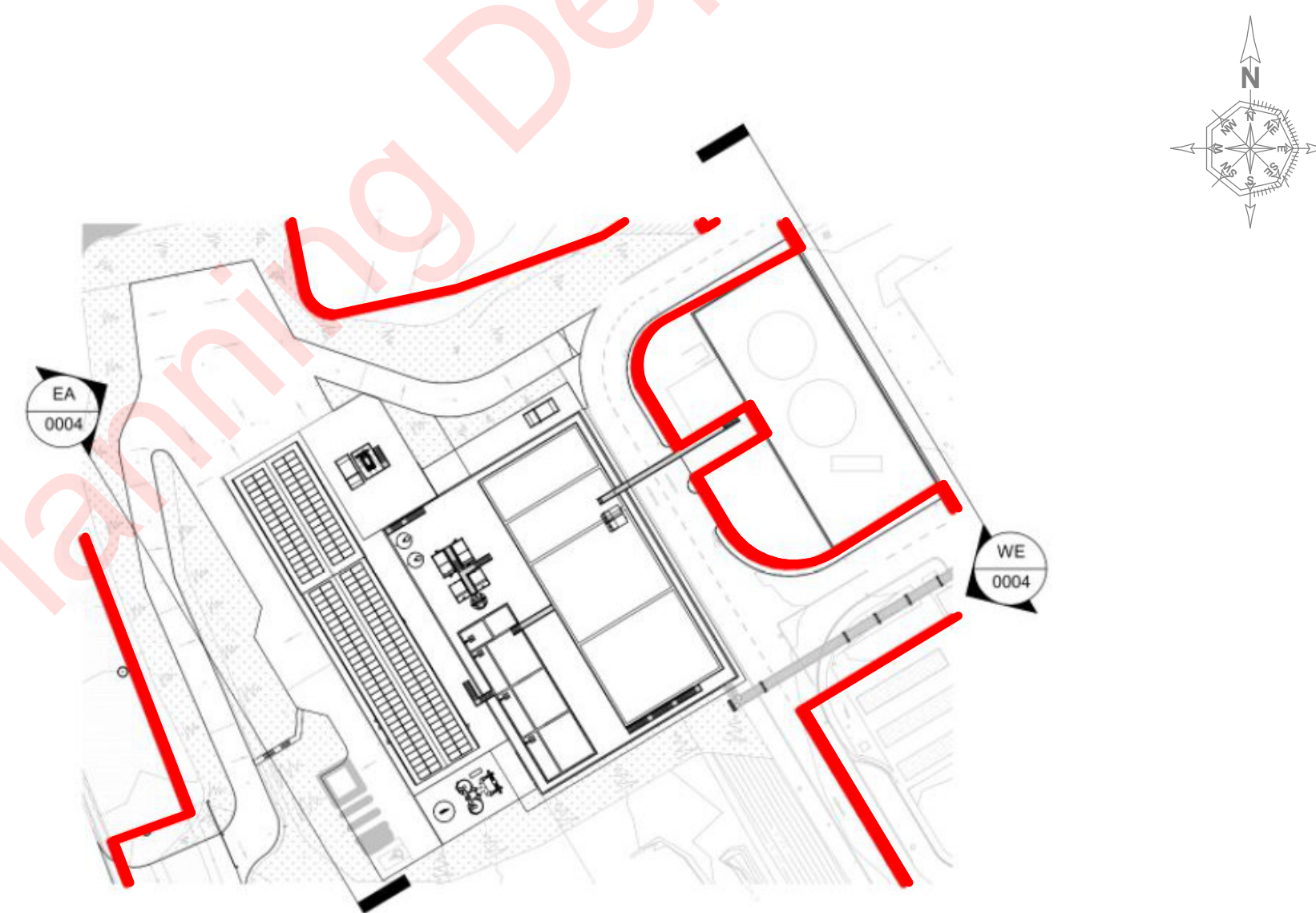

3
KEY PLAN 1
1 : 1000

NOTES

THIS DRAWING SHOULD BE READ IN CONJUNCTION WITH THE FOLLOWING DRAWINGS:
1011-000121-M6-XX-XX-DR-M-1101 GENERAL SITE LAYOUT
1011-000121-M6-XX-XX-DR-M-1105 SITE ELEVATIONS 02

ALL CIVIL & SITE DRAWINGS

SEE DRAWING 1011-000121-M6-XX-XX-DR-E-1112 FOR LIGHTING DETAILS

The details provided will be subject to detailed design and agreed with the Planning Authority in advance of construction, in the event of a grant of permission.

| PO5 | 30/07/2024 | ISSUED FOR PLANNING PERMISSION | EO | MB | AH |
|-----|------------|--------------------------------|-----|-----|-----|
| REV | DATE | DESCRIPTION | DRW | CHK | APP |

PLANNING STAGE

COPYRIGHT RESERVED - THIS DRAWING IS NOT TO BE USED FOR A PURPOSE OTHER THAN THAT FOR WHICH IT HAS BEEN ISSUED BY GLANUA LTD. NOR IS IT TO BE COPIED OR REPRODUCED IN ANY MANNER WITHOUT WRITTEN CONSENT.

CLIENT

WuXi Biologics
Global Solution Provider

WuXi Biologics
Mullaghlin,
Dundalk,
Co. Louth, A91 X56F.

PROJECT

**EFFLUENT BALANCING & RESOURCE
RECOVERY SYSTEM PROJECT**

Glanua

Glanua Ltd.,
Railway House,
Station Road,
Loughrea,
Co. Galway,
IRELAND

Tel: +353 (0)909 630 301
Fax: +353 (0)909 630 300
e-mail: info@glanua.com
web: www.glanua.com

TITLE

SITE ELEVATIONS 01

| SCALES | DRAWN | CHECKED | APPROVED |
|--------------|--------------------|--------------------|--------------------|
| As indicated | EO | MB | AH |
| | DATE 25/06/2024 | DATE 25/06/2024 | DATE 25/06/2024 |

| DRAWING No. | STATUS | REVISION |
|--------------------------------|--------|----------|
| 1011-000121-M6-XX-XX-DR-M-1104 | S2 | P05 |

NOTES

THIS DRAWING SHOULD BE READ IN CONJUNCTION WITH THE FOLLOWING DRAWINGS:
1011-000121-M6-XX-XX-DR-M-1101 GENERAL SITE LAYOUT
1011-000121-M6-XX-XX-DR-M-1105 SITE ELEVATIONS 01

ALL CIVIL & SITE DRAWINGS

SEE DRAWING 1011-000121-M6-XX-XX-DR-E-1112 FOR LIGHTING DETAILS

The details provided will be subject to detailed design and agreed with the Planning Authority in advance of construction, in the event of a grant of permission.

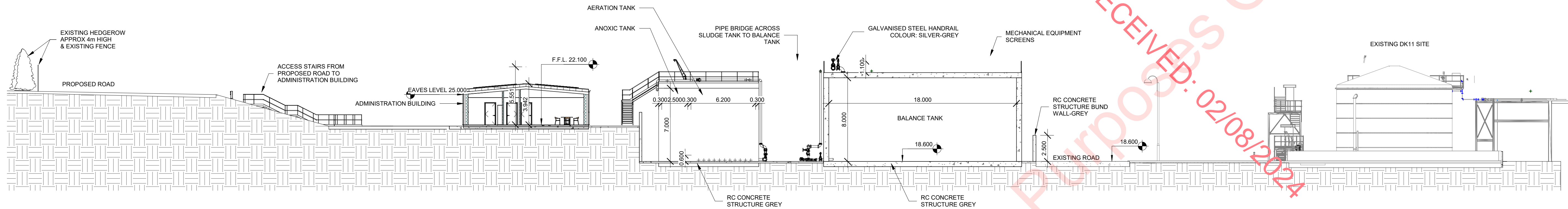

SO SOUTH
1 : 200

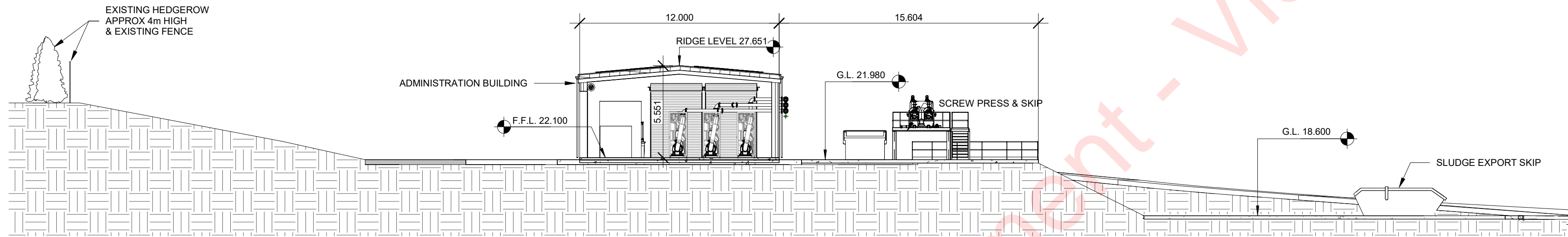

NO NORTH
1 : 200

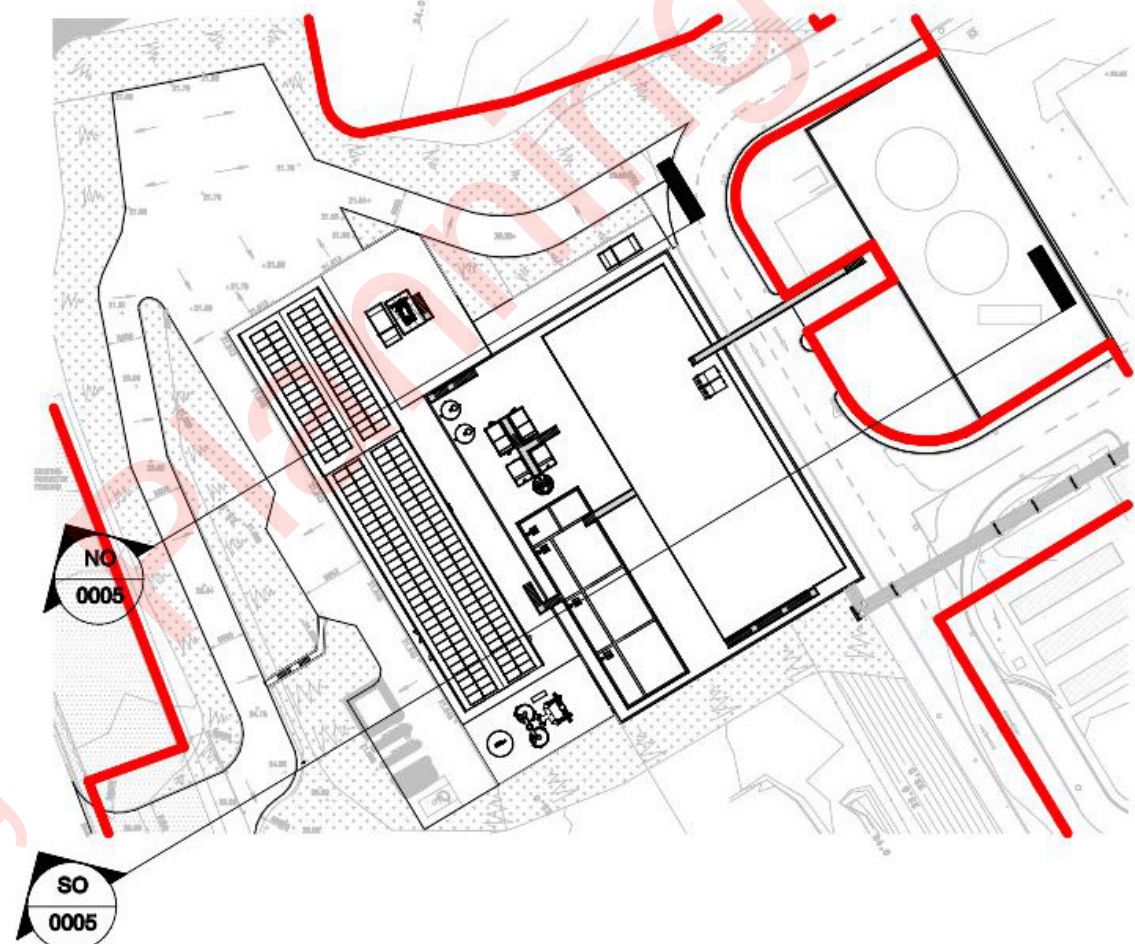

1 KEY PLAN 2
1 : 1000

| | | | | | |
|-----|------------|--------------------------------|-----|-----|-----|
| P05 | 30/07/2024 | ISSUED FOR PLANNING PERMISSION | EO | MB | AH |
| REV | DATE | DESCRIPTION | DRW | CHK | APP |

PLANNING STAGE

COPYRIGHT RESERVED - THIS DRAWING IS NOT TO BE USED FOR A PURPOSE OTHER THAN THAT FOR WHICH IT HAS BEEN ISSUED BY GLANUA LTD. NOR IS IT TO BE COPIED OR REPRODUCED IN ANY MANNER WITHOUT WRITTEN CONSENT.

CLIENT

WuXi Biologics
Global Solution Provider
WuXi Biologics
Mullighanlin,
Dundalk,
Co. Louth, A91 X56F.

PROJECT

**EFFLUENT BALANCING & RESOURCE
RECOVERY SYSTEM PROJECT**

Glanua

Glanua Ltd.,
Railway House,
Station Road,
Loughrea,
Co. Galway,
IRELAND

Tel: +353 (0)909 630 301
Fax: +353 (0)909 630 300
e-mail: info@glanua.com
web: www.glanua.com

TITLE

SITE ELEVATIONS 02

| | | | |
|--------------|------------|------------|------------|
| SCALES | DRAWN | CHECKED | APPROVED |
| As indicated | EO | MB | AH |
| | DATE | DATE | DATE |
| | 25/06/2024 | 25/06/2024 | 25/06/2024 |

| | | |
|--------------------------------|--------|----------|
| DRAWING No. | STATUS | REVISION |
| 1011-000121-M6-XX-XX-DR-M-1105 | S2 | P05 |

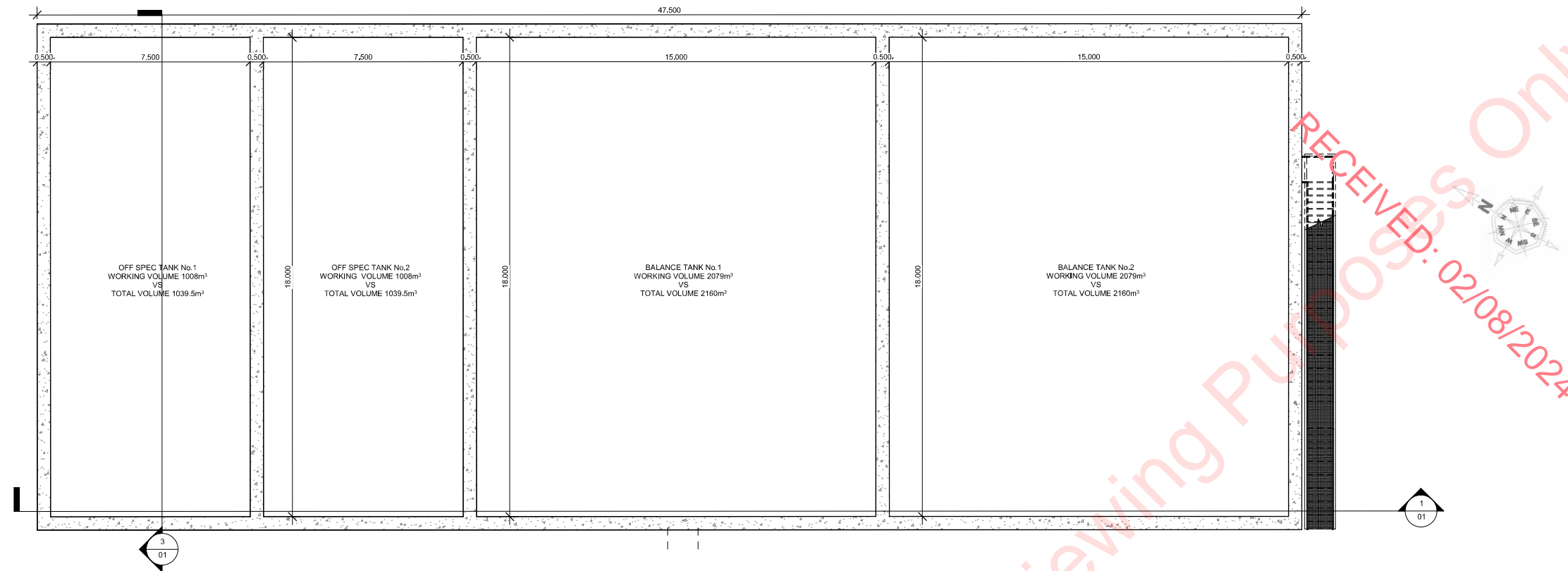

2 BALANCE & OFF SPEC TANKS LOW LVL PLAN
1 : 100

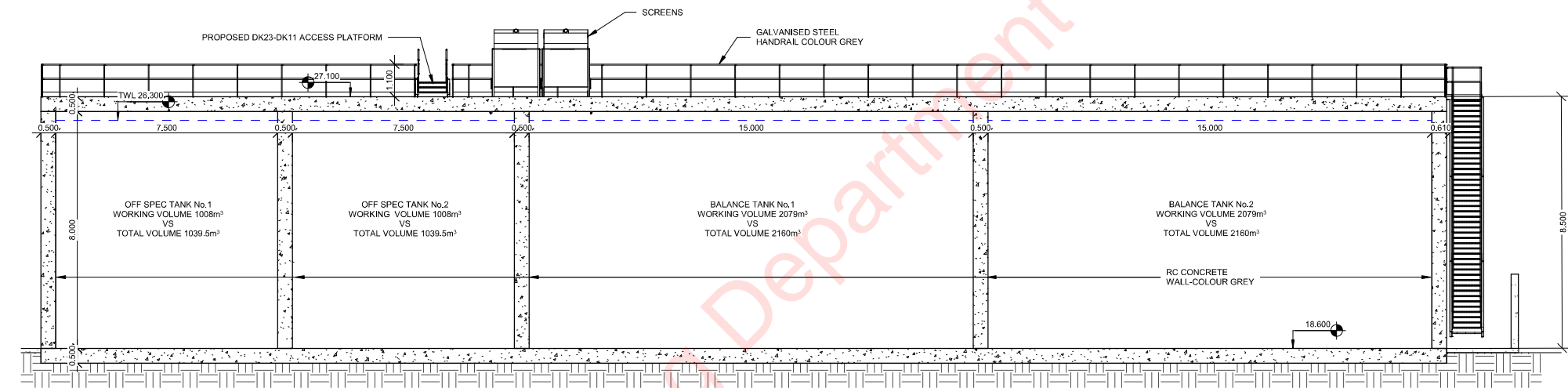

1 BALANCE & OFF SPEC TANK SECTIONS
1 : 100

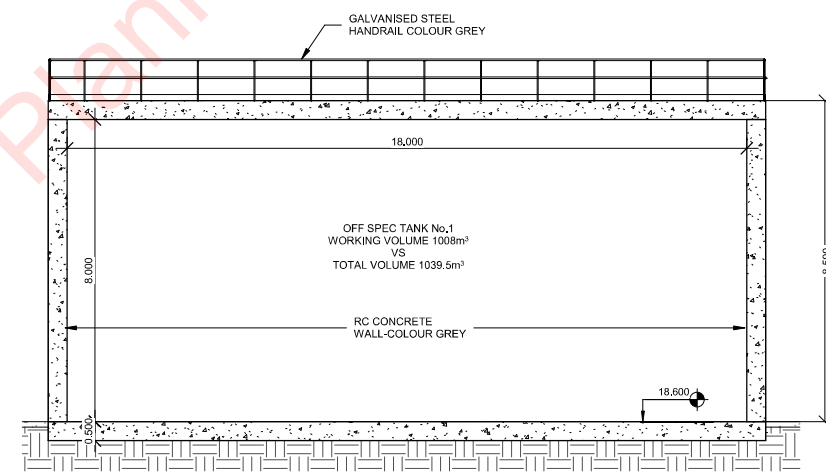

3 OFF SPEC TANK SECTION
1 : 100

NOTES

The details provided will be subject to detailed design and agreed with the Planning Authority in advance of construction, in the event of a grant of permission

| | | | | | |
|-----|------------|--------------------------------|-----|-----|-----|
| P05 | 30/07/2024 | ISSUED FOR PLANNING PERMISSION | EO | MB | AH |
| REV | DATE | DESCRIPTION | DRW | CHK | APP |

PLANNING STAGE

COPYRIGHT RESERVED - THIS DRAWING IS NOT TO BE USED FOR A PURPOSE OTHER THAN THAT FOR WHICH IT HAS BEEN ISSUED BY GLANUA LTD. NOR IS IT TO BE COPIED OR REPRODUCED IN ANY MANNER WITHOUT WRITTEN CONSENT.

CLIENT

WuXi Biologics

Global Solution Provider

WuXi Biologics

Mullagharlin,

Dundalk,

Co. Louth, A91 X56F.

PROJECT

EFFLUENT BALANCING & RESOURCE RECOVERY SYSTEM PROJECT

Glanua

Glanua Ltd.,

Railway House,

Station Road,

Loughrea,

Co. Galway,

IRELAND

Tel: +353 (0)909 630 301

Fax: +353 (0)909 630 300

e-mail: info@glanua.com

web: www.glanua.com

TITLE

BALANCE & OFF SPEC TANK
PLAN & SECTIONS

| | | | |
|---------|------------|------------|------------|
| SCALES | DRAWN | CHECKED | APPROVED |
| 1 : 100 | EO | MB | AH |
| | DATE | DATE | DATE |
| | 25/06/2024 | 25/06/2024 | 25/06/2024 |

| | | |
|--------------------------------|--------|----------|
| DRAWING No. | STATUS | REVISION |
| 1011-000121-M6-XX-XX-DR-M-1107 | S2 | P05 |

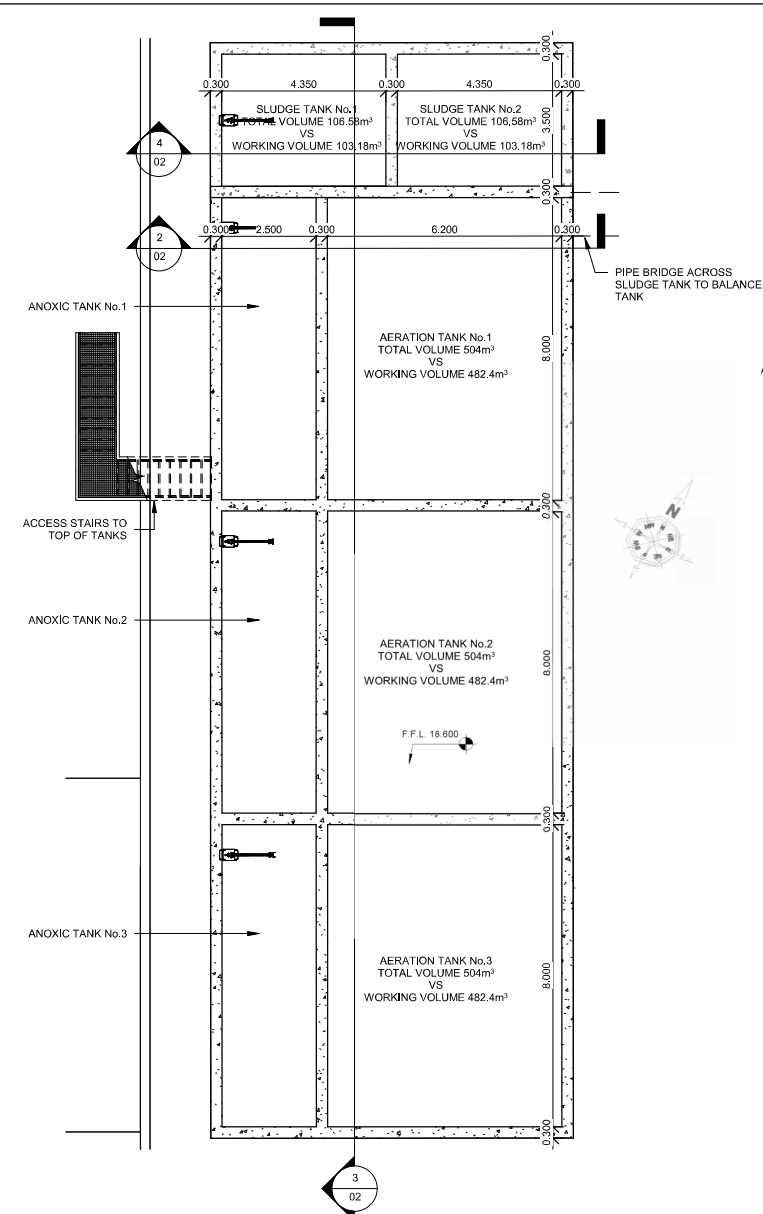

1 AERATION TANK, ANOXIC TANK & SLUDGE TANK PLAN
1 : 100

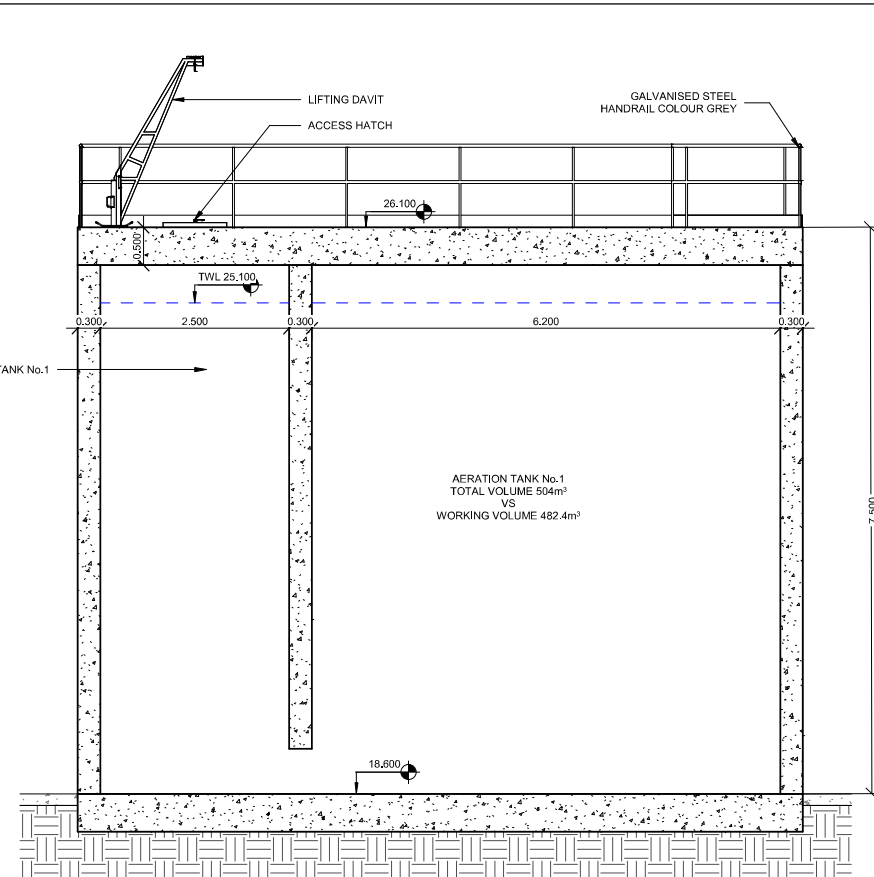

2 AERATION TANK & ANOXIC TANK SECTION
1 : 50

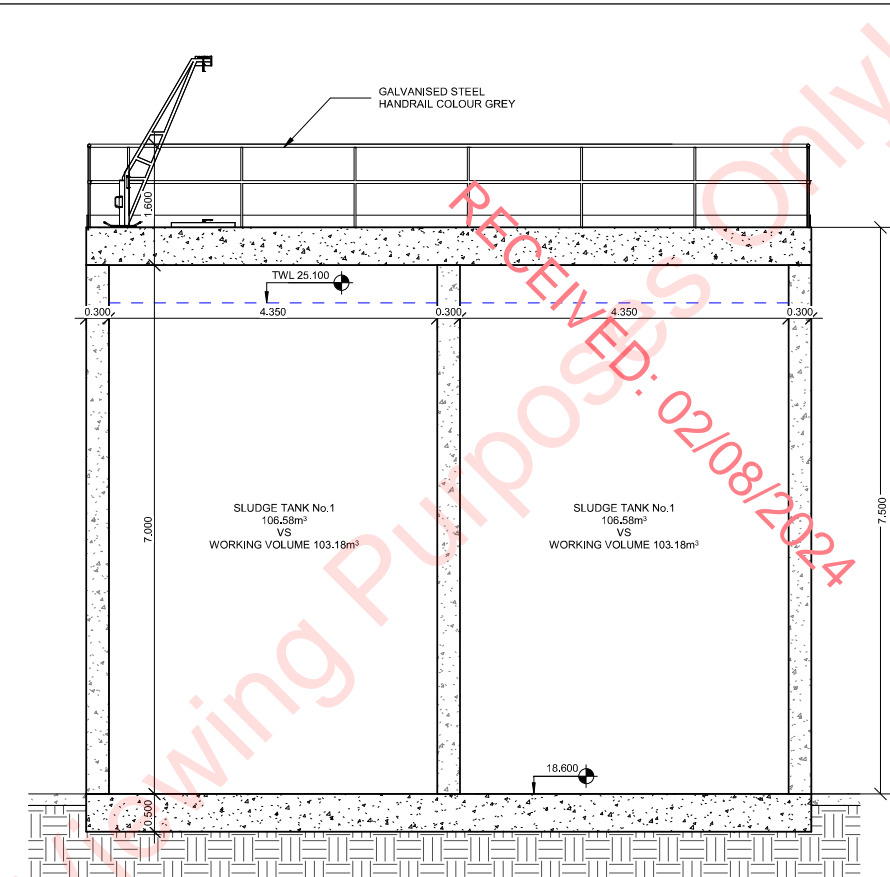

4 SLUDGE TANK SECTION
1 : 50

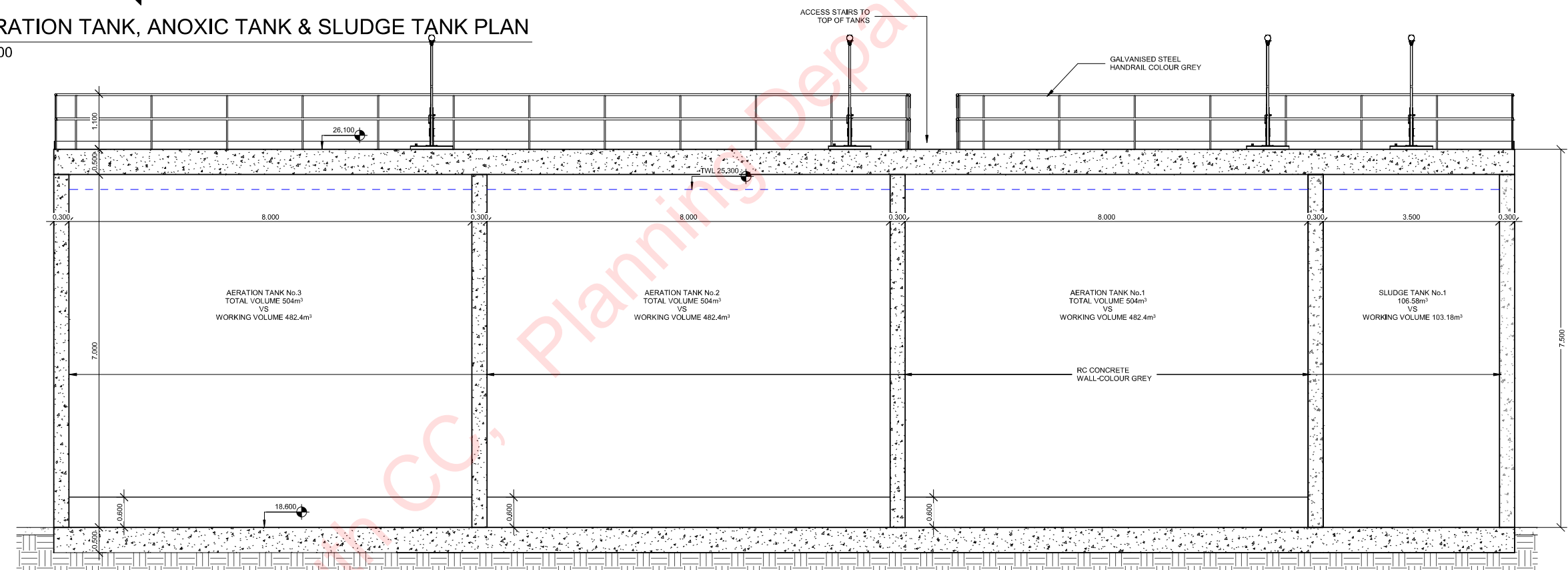

3 AERATION TANK & SLUDGE TANK SECTION
1 : 50

NOTES

The details provided will be subject to detailed design and agreed with the Planning Authority in advance of construction, in the event of a grant of permission

| REV | DATE | DESCRIPTION | DRW | CHK | APP |
|-----|------------|--------------------------------|-----|-----|-----|
| P05 | 30/07/2024 | ISSUED FOR PLANNING PERMISSION | EO | MB | AH |

PLANNING STAGE

COPYRIGHT RESERVED - THIS DRAWING IS NOT TO BE USED FOR A PURPOSE OTHER THAN THAT FOR WHICH IT HAS BEEN ISSUED BY GLANUA LTD. NOR IS IT TO BE COPIED OR REPRODUCED IN ANY MANNER WITHOUT WRITTEN CONSENT.

CLIENT

WuXi Biologics
Global Solution Provider
WuXi Biologics
Mullagharlin,
Dundalk,
Co. Louth, A91 X56F.

PROJECT

**EFFLUENT BALANCING & RESOURCE
RECOVERY SYSTEM PROJECT**

Glanua

Glanua Ltd.,
Railway House,
Station Road,
Loughrea,
Co. Galway,
IRELAND

Tel: +353 (0)909 630 301
Fax: +353 (0)909 630 300
e-mail: info@glanua.com
web: www.glanua.com

TITLE

**AERATION TANK, ANOXIC TANK
& SLUDGE TANK PLAN AND SECTIONS**

| SCALES | DRAWN | CHECKED | APPROVED |
|--------------|------------|------------|------------|
| As indicated | EO | MB | AH |
| DATE | DATE | DATE | DATE |
| 25/06/2024 | 25/06/2024 | 25/06/2024 | 25/06/2024 |

| DRAWING No. | STATUS | REVISION |
|--------------------------------|--------|----------|
| 1011-000121-M6-XX-XX-DR-M-1108 | S2 | P05 |

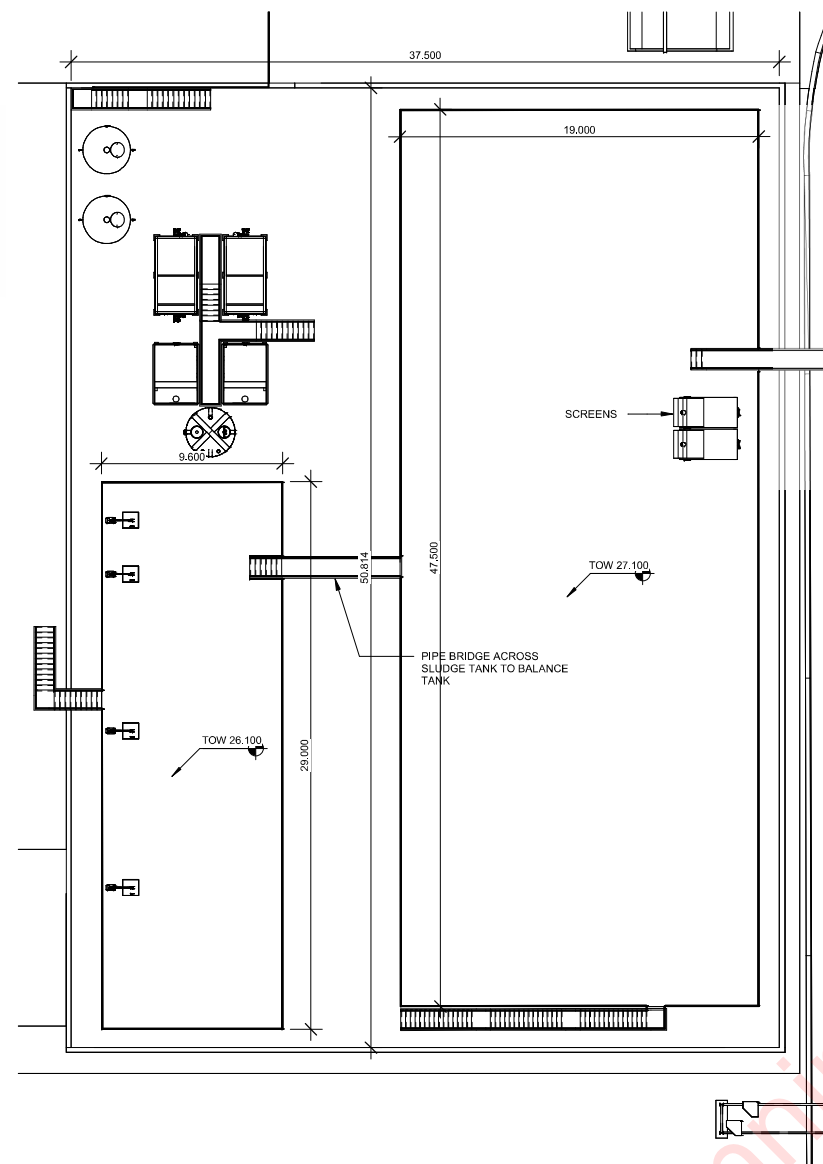

1 BUNDED AREA HIGH LVL PLAN
1 : 200

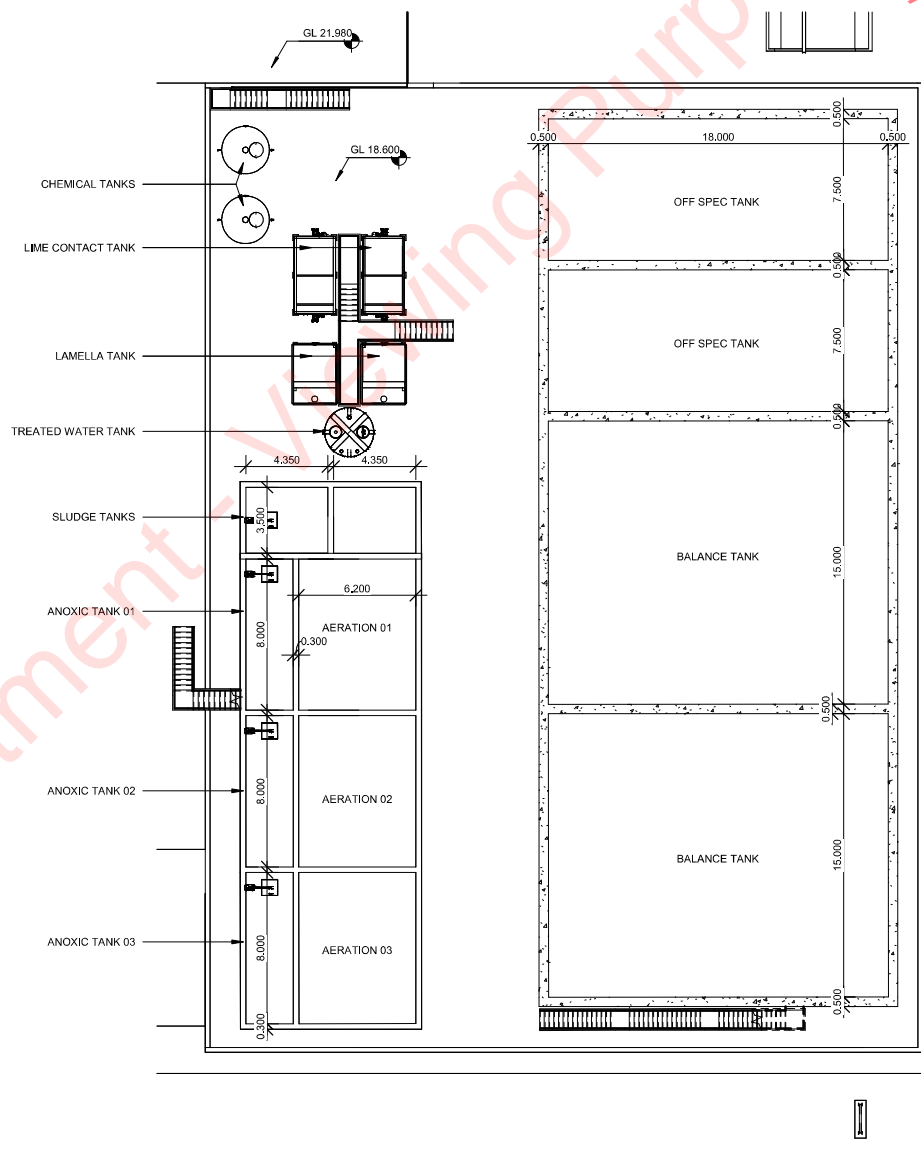

2 BUNDED AREA LOW LVL PLAN
1 : 200

NOTES

The details provided will be subject to detailed design and agreed with the Planning Authority in advance of construction, in the event of a grant of permission

| REV | DATE | DESCRIPTION | DRW | CHK | APP |
|-----|------------|--------------------------------|-----|-----|-----|
| P05 | 30/07/2024 | ISSUED FOR PLANNING PERMISSION | EO | MB | AH |

PLANNING STAGE

COPYRIGHT RESERVED - THIS DRAWING IS NOT TO BE USED FOR A PURPOSE OTHER THAN THAT FOR WHICH IT HAS BEEN ISSUED BY GLANUA LTD. NOR IS IT TO BE COPIED OR REPRODUCED IN ANY MANNER WITHOUT WRITTEN CONSENT.

CLIENT

WuXi Biologics
Global Solution Provider

WuXi Biologics
Mullagharlin,
Dundalk,
Co. Louth, A91 X56F.

PROJECT

**EFFLUENT BALANCING & RESOURCE
RECOVERY SYSTEM PROJECT**

Glanua

Glanua Ltd.,
Railway House,
Station Road,
Loughrea,
Co. Galway,
IRELAND

Tel: +353 (0)909 630 301
Fax: +353 (0)909 630 300
e-mail: info@glanua.com
web: www.glanua.com

TITLE

BUNDED AREA HIGH & LOW VIEWS

| SCALES | DRAWN PH | CHECKED MB | APPROVED AH |
|---------|--------------------|--------------------|--------------------|
| 1 : 200 | DATE 25/06/2024 | DATE 25/06/2024 | DATE 25/06/2024 |

| DRAWING No. | STATUS | REVISION |
|--------------------------------|--------|----------|
| 1011-000121-M6-XX-XX-DR-M-1252 | S2 | P05 |

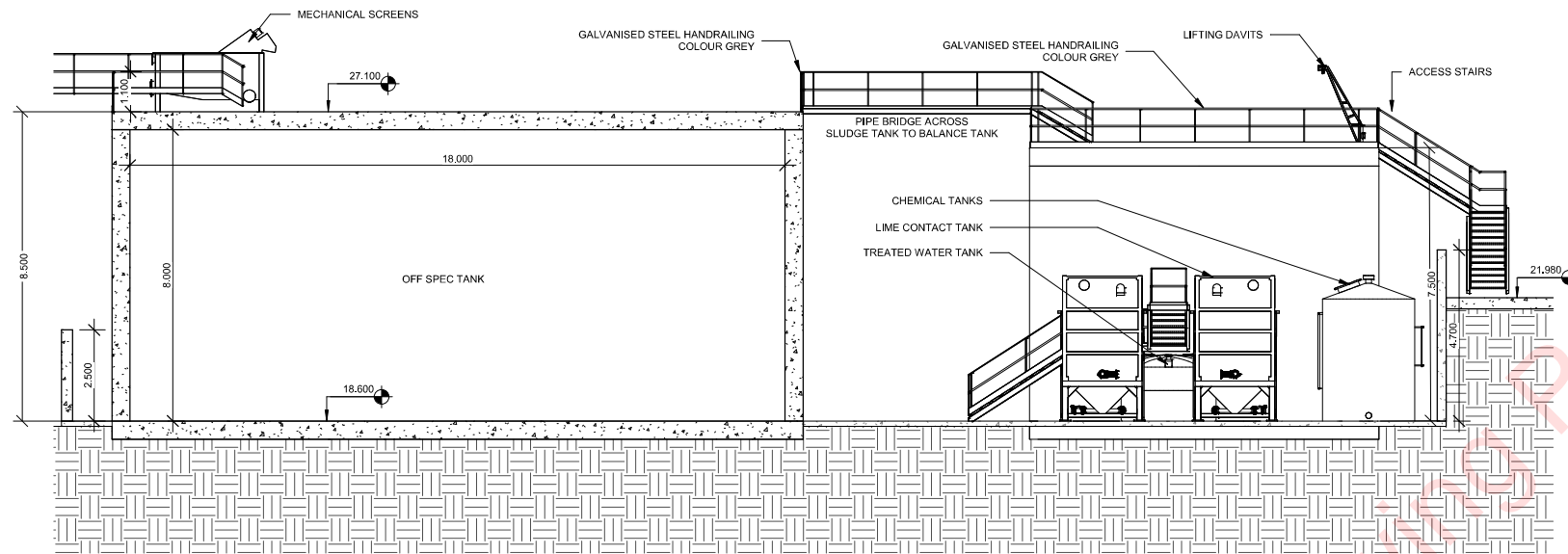

A SECTION A
1 : 100

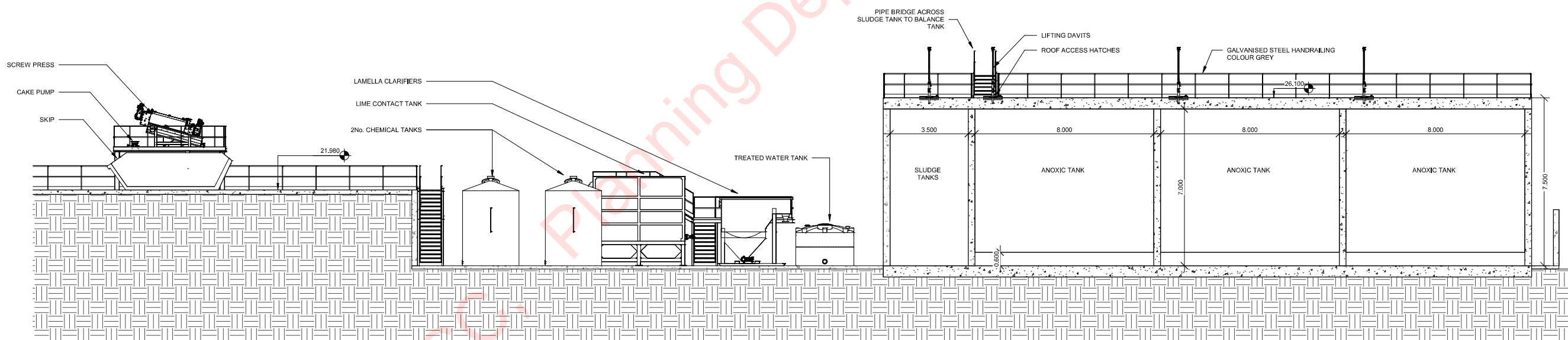

B SECTION B
1 : 100

NOTES

THIS DRAWING SHOULD BE READ IN CONJUNCTION WITH THE FOLLOWING DRAWINGS:
1011-000121-M6-XX-XX-DR-M-1101-SITE GENERAL ARRANGEMENT
1011-000121-M6-XX-XX-DR-M-1104-SITE SECTIONS 01
1011-000121-M6-XX-XX-DR-M-1105-SITE SECTIONS 02
1011-000121-M6-XX-XX-DR-M-1107-BALANCE & OFF SPEC TANKS SECTIONS
1011-000121-M6-XX-XX-DR-M-1108-AERATION TANK, ANOXIC TANK & SLUDGE TANK PLAN AND SECTIONS
1011-000121-M6-XX-XX-DR-M-1112-FLOOR & ROOF PLANS
1011-000121-M6-XX-XX-DR-M-1113-ADMINISTRATION BUILDING SECTIONS
1011-000121-M6-XX-XX-DR-M-1110-ADMINISTRATION BUILDING ELEVATIONS
1011-000121-M6-XX-XX-DR-M-1252-BUNDED AREA HIGH & LOW VIEWS
ALL CIVIL/SITE LAYOUT DRAWINGS
SEE DRAWING 1011-000121-M6-XX-XX-DR-E-1112 FOR LIGHTING DETAILS
The details provided will be subject to detailed design and agreed with the Planning Authority in advance of construction, in the event of a grant of permission

| POS | 30/07/2024 | ISSUED FOR PLANNING PERMISSION | EO | MB | AH |
|-----|------------|--------------------------------|-----|-----|-----|
| REV | DATE | DESCRIPTION | DRW | CHK | APP |

PLANNING STAGE

COPYRIGHT RESERVED - THIS DRAWING IS NOT TO BE USED FOR A PURPOSE OTHER THAN THAT FOR WHICH IT HAS BEEN ISSUED BY GLANUA LTD. NOR IS IT TO BE COPIED OR REPRODUCED IN ANY MANNER WITHOUT WRITTEN CONSENT.

CLIENT

WuXi Biologics
Global Solution Provider
WuXi Biologics
Mulagharlin,
Dundalk,
Co. Louth, A91 X56F.

PROJECT

EFFLUENT BALANCING & RESOURCE RECOVERY SYSTEM PROJECT

Glanua

Glanua Ltd.,
Railway House,
Station Road,
Loughrea,
Co. Galway,
IRELAND

Tel: +353 (0)909 630 301
Fax: +353 (0)909 630 300
e-mail: info@glanua.com
web: www.glanua.com

TITLE

TYPICAL SECTIONS

| SCALES | DRAWN | CHECKED | APPROVED |
|--------------------------------|-----------------|------------|------------|
| 1 : 100 | EO | MB | AH |
| | DATE | DATE | DATE |
| | 25/06/2024 | 25/06/2024 | 25/06/2024 |
| DRAWING No. | STATUS REVISION | | |
| 1011-000121-M6-XX-XX-DR-M-1255 | S2 P05 | | |

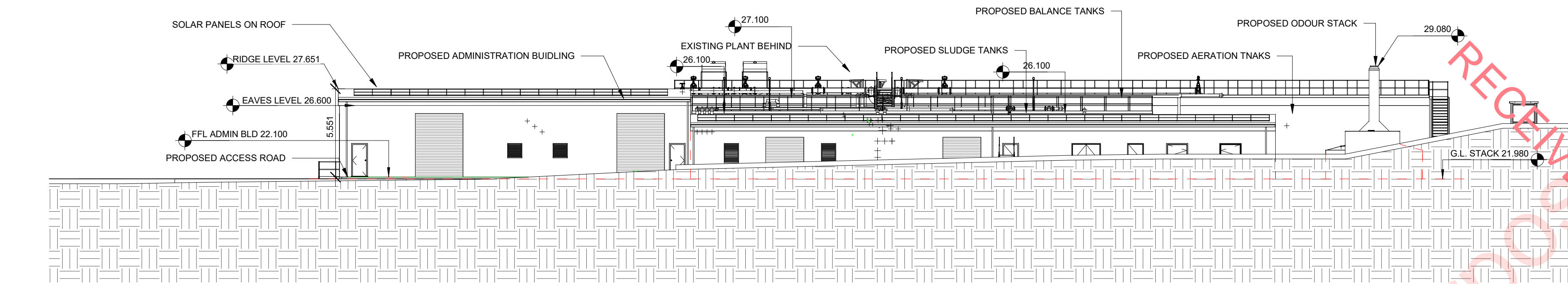

EA EAST
1 : 200

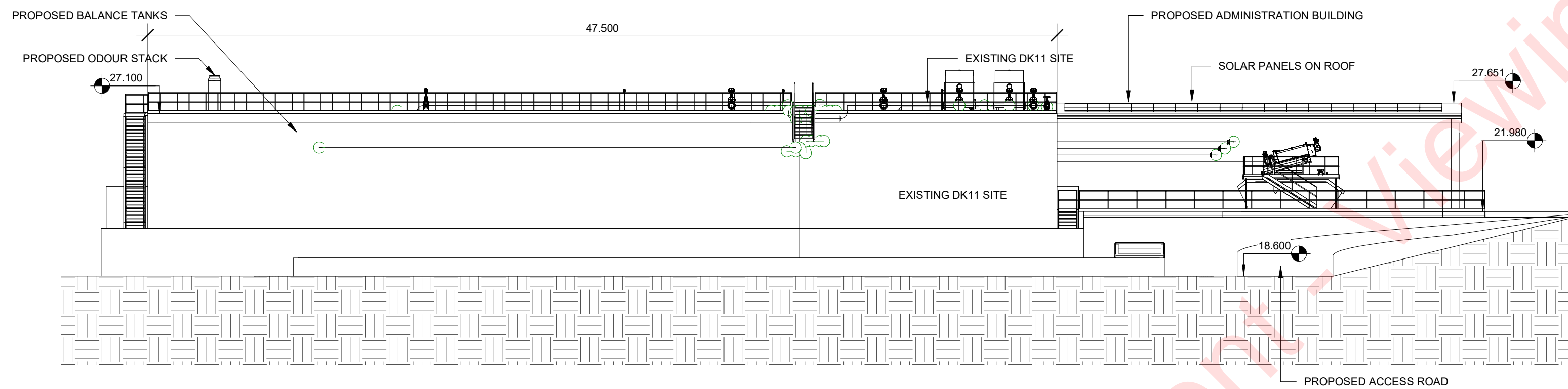

WE WEST
1 : 200

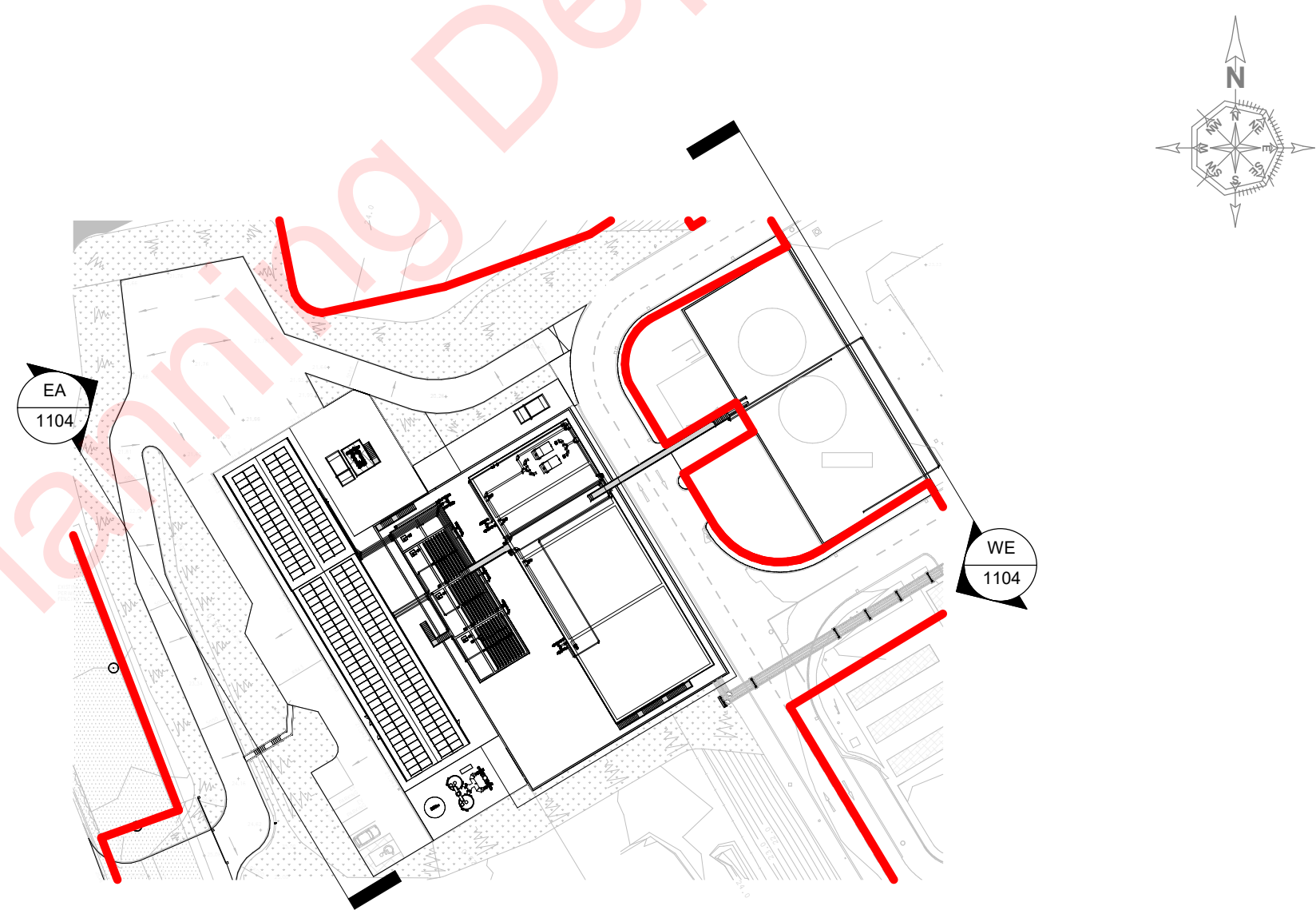

3 KEY PLAN 1
1 : 1000

NOTES

THIS DRAWING SHOULD BE READ IN CONJUNCTION WITH THE FOLLOWING DRAWINGS:
1011-000121-M6-XX-XX-DR-M-1101 GENERAL SITE LAYOUT
1011-000121-M6-XX-XX-DR-M-1105 SITE ELEVATIONS 02

ALL CIVIL & SITE DRAWINGS

SEE DRAWING 1011-000121-M6-XX-XX-DR-E-1112 FOR LIGHTING DETAILS

The details provided will be subject to detailed design and agreed with the Planning Authority in advance of construction, in the event of a grant of permission.

| | | | | | |
|-----|------------|--------------------------------|-----|-----|-----|
| P05 | 31/07/2024 | ISSUED FOR PLANNING PERMISSION | EO | MB | AH |
| REV | DATE | DESCRIPTION | DRW | CHK | APP |

PLANNING STAGE

COPYRIGHT RESERVED - THIS DRAWING IS NOT TO BE USED FOR A PURPOSE OTHER THAN THAT FOR WHICH IT HAS BEEN ISSUED BY GLANUA LTD. NOR IS IT TO BE COPIED OR REPRODUCED IN ANY MANNER WITHOUT WRITTEN CONSENT.

CLIENT

WuXi Biologics
Mullighanlin,
Dundalk,
Co. Louth, A91 X56F.

PROJECT

EFFLUENT BALANCING & RESOURCE
RECOVERY SYSTEM PROJECT

Glanua Ltd.,
Railway House,
Station Road,
Loughrea,
Co. Galway,
IRELAND

Tel: +353 (0)909 630 301
Fax: +353 (0)909 630 300
e-mail: info@glanua.com
web: www.glanua.com

TITLE

SITE ELEVATIONS 01

| | | | |
|------------------------|--------------------|--------------------|--------------------|
| SCALES As indicated | DRAWN EO | CHECKED MB | APPROVED AH |
| | DATE 25/06/2024 | DATE 25/06/2024 | DATE 25/06/2024 |

| | | |
|---|----|-----|
| DRAWING No. 1011-000121-M6-XX-XX-DR-M-1104 | S2 | P05 |
|---|----|-----|

NOTES

1. DO NOT SCALE IF IN DOUBT ASK.
2. LEVELS RELATE TO POOLBEG.
3. ALL WORK ON THE SITE TO BE IN ACCORDANCE WITH THE SAFETY, HEALTH, AND WELFARE AT WORK (CONSTRUCTION) REGULATIONS 2013.
4. ALL DIMENSIONS ARE IN MILLIMETERS
5. ALL LEVELS SHOWN ARE IN M.O.D.

LANDS UNDER THE CONTROL OF THE APPLICANT
BOUNDARY TO WHICH THE APPLICATION RELATES
AREA = 78,867m²/7.886Hectares

ROAD SPECIFICATION
40mm STONE MASTIC ASPHALT SURFACE COURSE
60mm DENSE BITUMEN MACADAM BINDER COURSE
100mm DBM ROAD BASE
OVER A TYPE B GRANULAR MATERIAL TO SERIES
800 AND TYPE 8F2 CAPPING LAYER TO SERIES 600
OF THE TII SPECIFICATION FOR ROADWORKS.
PRECAST KERBS EITHER SIDE OF ROADWAY

CONCRETE SURFACE (EXTERNAL YARD/ PATH/ ROOF)

SOFT LANDSCAPING TO EMBANKMENT - GRASS SEEDING

SOFT LANDSCAPING TO EMBANKMENT - WILD FLOWER PLANTED AREA

NEW SPOIL HEAP FORMED FROM EXCAVATED MATERIAL FROM PROPOSED WORKS (ROUGH PASTURE FINISH)

6m WIDE TEMPORARY HAUL ROAD (INCLUDING 1.2m PATH) FOR CONSTRUCTION ACCESS
50mm QUARRY SCREENINGS ON
150mm SR21 MATERIAL ON
6F2 CAPPING LAYER -
ALLOW PROVISIONAL OF 250mm LAYER OF 6F2

PERMANENT RIGHT OF WAY FOR GAS

TEMPORARY CONTRACTORS COMPOUND -
REFER TO FGCL DRAWINGS
1011-000121-FGCL-XX-XX-DR-C-1025&1026
AREA TO BE FULLY REINSTATED TO MATCH EXISTING PRIOR TO COMMENCEMENT OF THE DEVELOPMENT (GRASS SEEDING).

EXISTING ROAD

DOUBLE CONTAINED RISING MAIN

TEMPORARY ROAD TO COMPOUND

The details provided will be subject to detailed design and agreed with the Planning Authority in advance of construction, in the event of a grant of permission.

| | | | | | |
|-----|------------|--------------------------------|----|----|----|
| P05 | 30/07/2024 | ISSUED FOR PLANNING PERMISSION | JH | MB | AH |
| REV | DATE | DESCRIPTION | D | C | A |

PLANNING STAGE

COPYRIGHT RESERVED - THIS DRAWING IS NOT TO BE USED FOR A PURPOSE OTHER THAN THAT FOR WHICH IT HAS BEEN ISSUED BY GLAN AGUA LTD. NOR IS IT TO BE COPIED OR REPRODUCED IN ANY MANNER WITHOUT WRITTEN CONSENT.

CLIENT
WuXi Biologics
Global Solution Provider

MULLAGHARLIN,
DUNDALK, CO. LOUTH, IRELAND.
A91 X56F

PROJECT
**EFFLUENT BALANCING &
RESOURCE RECOVERY SYSTEM
PROJECT**

Glanua

Glanua Ltd.,
Railway House,
Station Road,
Loughrea,
Co. Galway,
IRELAND
Tel: +353 (0)909 630 301
Fax: +353 (0)909 630 300
e-mail: info@glanagua.com
www.glanagua.com

KEYPLAN OF PROPOSED
WORKS INCLUDING RED LINE
BOUNDARY

| | | | |
|-----------------------------------|------------|------------|------------|
| SCALE | DRAWN | CHECKED | APPROVED |
| 1:1000 | AH | AH | AH |
| | DATE | DATE | DATE |
| | 10/06/2024 | 10/06/2024 | 10/06/2024 |
| DRAWING No. | STATUS | REVISION | |
| 1011-000121-FGCL-XX-XX-DR-C-0005A | S2 | P05 | |

NOTES
1. DO NOT SCALE IF IN DOUBT ASK.
2. LEVELS RELATE TO MAIN HEAD.
3. ALL WORK ON THE SITE TO BE IN ACCORDANCE WITH THE SAFETY, HEALTH, AND WELFARE AT WORK (CONSTRUCTION) REGULATIONS 2013.
4. ALL DIMENSIONS ARE IN MILLIMETERS
5. ALL LEVELS SHOWN ARE IN M O.D.

LANDS UNDER THE CONTROL OF THE APPLICANT
BOUNDARY TO WHICH THE APPLICATION RELATES
AREA = 78.867m²/77.886Hectares

+6.84 - EXISTING LEVELS
+6.84 - PROPOSED LEVELS

ROAD SPECIFICATION
40mm HOT ROLLED ASPHALT SURFACE COURSE
60mm DENSE BITUMEN MACADAM BINDER COURSE
100mm DBM ROAD BASE
OVER A TYPE B GRANULAR MATERIAL TO SERIES 800 AND TYPE 6F2 CAPPING LAYER TO SERIES 600 OF THE TII SPECIFICATION FOR ROADWORKS.
PRECAST KERBS EITHER SIDE OF ROADWAY

CONCRETE SURFACE (EXTERNAL YARD/ PATH)
CONCRETE SURFACE (TANK ROOFS)
SOFT LANDSCAPING TO EMBANKMENT - GRASS SEEDING
SOFT LANDSCAPING TO EMBANKMENT - WILD FLOWER PLANTED AREA
PERMANENT RIGHT OF WAY FOR GAS

TEMPORARY CONTRACTORS COMPOUND - REFER TO FGCL DRAWINGS 1011-000121-FGCL-XX-XX-DR-C-1025&1026 AREA TO BE FULLY REINSTATED TO MATCH EXISTING PRIOR TO COMMENCEMENT OF THE DEVELOPMENT (GRASS SEEDED).

EXISTING ROAD
EMBANKMENT SLOPED AT MAX 1:2
WATER FLOW DIRECTION

NOTE A: CONTRACTORS COMPOUND
LOCATION OF TEMPORARY CONTRACTORS COMPOUND REQUIRED TO FACILITATE THE CONSTRUCTION OF THE PERMANENT WORKS. CONTRACTORS COMPOUND TO COMPRISE OF 15m LONG X 3m WIDE X 3m HIGH METAL 'SHIPPING' TYPE CONTAINERS (COLOUR: GREEN). TOPSOIL TO BE STRIPPED (AND STORED ON SITE FOR LATER REUSE) TO ALLOW PLACEMENT OF TEMPORARY STONE FILL. AREA TO BE FULLY REINSTATED BACK TO SOFT LANDSCAPING UPON COMPLETION OF THE WORKS. REFER TO CONTRACTORS PROPOSED CONSTRUCTION & ENVIRONMENTAL MANAGEMENT PLAN (CEMP) FOR FURTHER DETAILS. EXACT LAYOUT AND NUMBER OF CONTAINERS REQUIRED TO BE DETERMINED AT DETAILED DESIGN STAGE.

NOTE:
PLEASE BE ADVISED THAT THE INFORMATION SHOWN WILL BE SUBJECT TO DETAILED DESIGN AND AGREED WITH THE PLANNING AUTHORITY IN ADVANCE OF CONSTRUCTION, IN THE EVENT OF A GRANT OF PERMISSION.

NOTE:
PLEASE REFER TO DRAWING 1011-000121-FGCL-XX-XX-DR-C-1005A FOR DISTANCES OF THE PROPOSED STRUCTURES/BUILDINGS TO THE RED LINE BOUNDARY.

| REV | DATE | DESCRIPTION | D | C | A |
|-----|------------|--------------------------------|----|----|----|
| P05 | 10/06/2024 | ISSUED FOR PLANNING PERMISSION | EO | AH | AH |

PLANNING STAGE

COPYRIGHT RESERVED - THIS DRAWING IS NOT TO BE USED FOR A PURPOSE OTHER THAN THAT FOR WHICH IT HAS BEEN ISSUED BY GLAN AGUA LTD. NOR IS IT TO BE COPIED OR REPRODUCED IN ANY MANNER WITHOUT WRITTEN CONSENT.

CLIENT
WuXi Biologics
Global Solution Provider
MULLAGHARLIN,
DUNDALK, CO. LOUTH, IRELAND.
A91 X56F

PROJECT
EFFLUENT BALANCING & RESOURCE RECOVERY SYSTEM PROJECT

Glanua

Glanua Ltd.,
Railway House,
Station Road,
Loughrea,
Co. Galway,
IRELAND
Tel: +353 (0)909 630 301
Fax: +353 (0)909 630 300
e-mail: info@glanagua.com
www.glanagua.com

TITLE
PROPOSED SITE LAYOUT

| SCALE | DRAWN | CHECKED | APPROVED |
|-----------------------------------|--------------------------|--------------------------|--------------------------|
| 1:250 | EO DATE 10/06/2024 | AH DATE 10/06/2024 | AH DATE 10/06/2024 |
| DRAWING No. | STATUS | REVISION | |
| 1011-000121-FGCL-XX-XX-DR-C-1005B | S2 | P05 | |

NOTES

1. DO NOT SCALE IF IN DOUBT ASK.

2. LEVELS RELATE TO MAIN HEAD.

3. ALL WORK ON THE SITE TO BE IN ACCORDANCE WITH THE SAFETY, HEALTH, AND WELFARE AT WORK (CONSTRUCTION) REGULATIONS 2013.

4. ALL DIMENSIONS ARE IN MILLIMETERS.

5. ALL LEVELS SHOWN ARE IN M O.D.

LANDS UNDER THE CONTROL OF THE APPLICANT

BOUNDARY TO WHICH THE APPLICATION RELATES

AREA = 78,867m²/77.886Hectares

+6.84

EXISTING LEVELS

+6.84

PROPOSED LEVELS

ROAD SPECIFICATION

40mm HOT ROLLED ASPHALT SURFACE COURSE

60mm DENSE BITUMEN MACADAM BINDER COURSE

100mm DSM ROAD BASE

OVER A TYPE B GRANULAR MATERIAL TO SERIES 800 AND TYPE 6F2 CAPPING LAYER TO SERIES 600 OF THE TII SPECIFICATION FOR ROADWORKS.

PRECAST KERBS EITHER SIDE OF ROADWAY

CONCRETE SURFACE (EXTERNAL YARD/ PATH)

CONCRETE SURFACE (TANK ROOFS)

SOFT LANDSCAPING TO EMBANKMENT - GRASS SEEDING

SOFT LANDSCAPING TO EMBANKMENT - WILD FLOWER PLANTED AREA

PERMANENT RIGHT OF WAY FOR GAS

TEMPORARY CONTRACTORS COMPOUND - REFER TO FGCL DRAWINGS

1011-000121-FGCL-XX-XX-DR-C-1025&1026

AREA TO BE FULLY REINSTATED TO MATCH EXISTING PRIOR TO COMMENCEMENT OF THE DEVELOPMENT (GRASS SEEDED).

EXISTING ROAD

EMBANKMENT SLOPED AT MAX 1:2

NOTE A: CONTRACTORS COMPOUND
LOCATION OF TEMPORARY CONTRACTORS COMPOUND REQUIRED TO FACILITATE THE CONSTRUCTION OF THE PERMANENT WORKS. CONTRACTORS COMPOUND TO COMPRISE OF 15m LONG X 3m. WIDE X 3m HIGH METAL 'SHIPPING' TYPE CONTAINERS (COLOUR: GREEN). TOPSOIL TO BE STRIPPED (AND STORED ON SITE FOR LATER REUSE) TO ALLOW PLACEMENT OF TEMPORARY STONE FILL. AREA TO BE FULLY REINSTATED BACK TO SOFT LANDSCAPING UPON COMPLETION OF THE WORKS. REFER TO CONTRACTORS PROPOSED CONSTRUCTION & ENVIRONMENTAL MANAGEMENT PLAN (CEMP) FOR FURTHER DETAILS. EXACT LAYOUT AND NUMBER OF CONTAINERS REQUIRED TO BE DETERMINED AT DETAILED DESIGN STAGE.

NOTE:
PLEASE BE ADVISED THAT THE INFORMATION SHOWN WILL BE SUBJECT TO DETAILED DESIGN AND AGREED WITH THE PLANNING AUTHORITY IN ADVANCE OF CONSTRUCTION, IN THE EVENT OF A GRANT OF PERMISSION.

NOTE:
PLEASE REFER TO DRAWING 1011-000121-FGCL-XX-XX-DR-C-1005A FOR DISTANCES OF THE PROPOSED STRUCTURES/BUILDINGS TO THE RED LINE BOUNDARY.

| | | | | | |
|-----|------------|--------------------------------|----|----|----|
| P04 | 10/06/2024 | ISSUED FOR PLANNING PERMISSION | EO | AH | AH |
| REV | DATE | DESCRIPTION | D | C | A |

PLANNING STAGE

COPYRIGHT RESERVED - THIS DRAWING IS NOT TO BE USED FOR A PURPOSE OTHER THAN THAT FOR WHICH IT HAS BEEN ISSUED BY GLAN AGUA LTD. NOR IS IT TO BE COPIED OR REPRODUCED IN ANY MANNER WITHOUT WRITTEN CONSENT.

CLIENT

WuXi Biologics

Global Solution Provider

MULLAGHARLIN,
DUNDALK, CO. LOUTH, IRELAND.
A91 X56F

PROJECT

EFFLUENT BALANCING & RESOURCE RECOVERY SYSTEM PROJECT

Glanua

Glanua Ltd.,
Railway House,
Station Road,
Loughrea,
Co. Galway,
IRELAND

Tel: +353 (0)909 630 301

Fax: +353 (0)909 630 300

e-mail: info@glanagua.com

www.glanagua.com

TITLE

PROPOSED SITE LAYOUT 1:500

| | | | |
|-----------------------------------|------------|------------|------------|
| SCALE | DRAWN | CHECKED | APPROVED |
| 1:500 | EO | AH | AH |
| | DATE | DATE | DATE |
| | 10/06/2024 | 10/06/2024 | 10/06/2024 |
| DRAWING No. | STATUS | | REVISION |
| 1011-000121-FGCL-XX-XX-DR-C-1005C | S2 | | P04 |

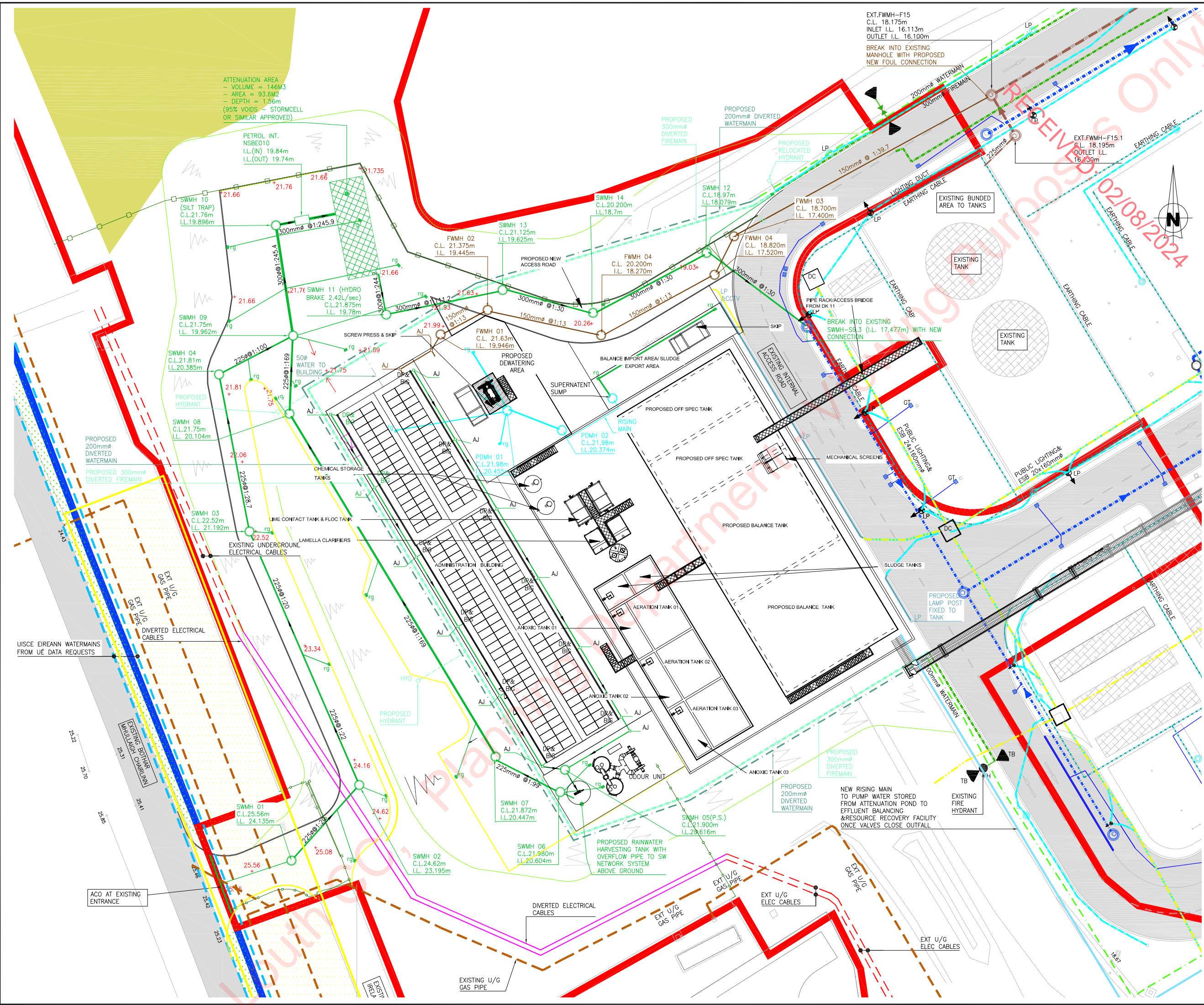

LANDS UNDER THE CONTROL OF THE APPLICANT

BOUNDARY TO WHICH THE APPLICATION RELATES

AREA = 78,867m²/7.886Hectares

+6.84 - EXISTING LEVELS

+6.84 - PROPOSED LEVELS

EXISTING GAS MAIN

EXISTING ESB LINES

EXISTING WATER (UISCE EIREANN)

EXISTING 200mmØ WATERMAIN

EXISTING 300mmØ FIREMAIN

EXISTING LIGHTING DUCT

EXISTING SURFACE WATER

EXISTING EARTHING CABLE

EXISTING FOUL SEWER

EXISTING ESB

PROPOSED DIVERTED CABLES

PROPOSED STORMWATER

PROPOSED WATERMAIN

PROPOSED FIREMAIN

PROPOSED FOUL

PROPOSED LIGHTING&CCTV

PROPOSED PROCESS DRAINAGE

PROPOSED RISING MAIN

PERMANENT RIGHT OF WAY FOR GAS

TEMPORARY CONTRACTORS COMPOUND - REFER TO FGCL DRAWINGS 1011-000121-FGCL-XX-XX-DR-C-1025&1026 AREA TO BE FULLY REINSTATED TO MATCH EXISTING PRIOR TO COMMENCEMENT OF THE DEVELOPMENT (GRASS SEEDED).

EXISTING ROAD

NOTE:

ALL LEVELS AND PIPE LAYOUT TO BE CONFIRMED AT DETAILED DESIGN STAGE AND ON-SITE FOR DETAILS ON EXTERNAL LIGHTING, PLEASE REFER TO MURPHY DRAWING 1011-000121-M6-XX-XX-DR-E-1112

The details provided will be subject to detailed design and agreed with the Planning Authority in advance of construction, in the event of a grant of permission,

| | | | | | |
|-----|------------|--------------------------------|----|----|----|
| P05 | 10/06/2024 | ISSUED FOR PLANNING PERMISSION | EO | AH | AH |
| REV | DATE | DESCRIPTION | D | C | A |

PLANNING STAGE

COPYRIGHT RESERVED - THIS DRAWING IS NOT TO BE USED FOR A PURPOSE OTHER THAN THAT FOR WHICH IT HAS BEEN ISSUED BY GLAN AGUA LTD. NOR IS IT TO BE COPIED OR REPRODUCED IN ANY MANNER WITHOUT WRITTEN CONSENT.

CLIENT

WuXi Biologics

Global Solution Provider

MULLAGHARLIN,
DUNDALK, CO. LOUTH, IRELAND.
A91 X56F

PROJECT

EFFLUENT BALANCING &
RESOURCE RECOVERY SYSTEM
PROJECT

TITLE

PROPOSED UNDERGROUND
SERVICES LAYOUT

SCALE

1:250

DRAWN

EO

DATE

10/06/2024

CHECKED

AH

DATE

10/06/2024

APPROVED

AH

DATE

10/06/2024

DRAWING No.

1011-000121-FGCL-XX-XX-DR-C-1006

STATUS

S2

REVISION

P05

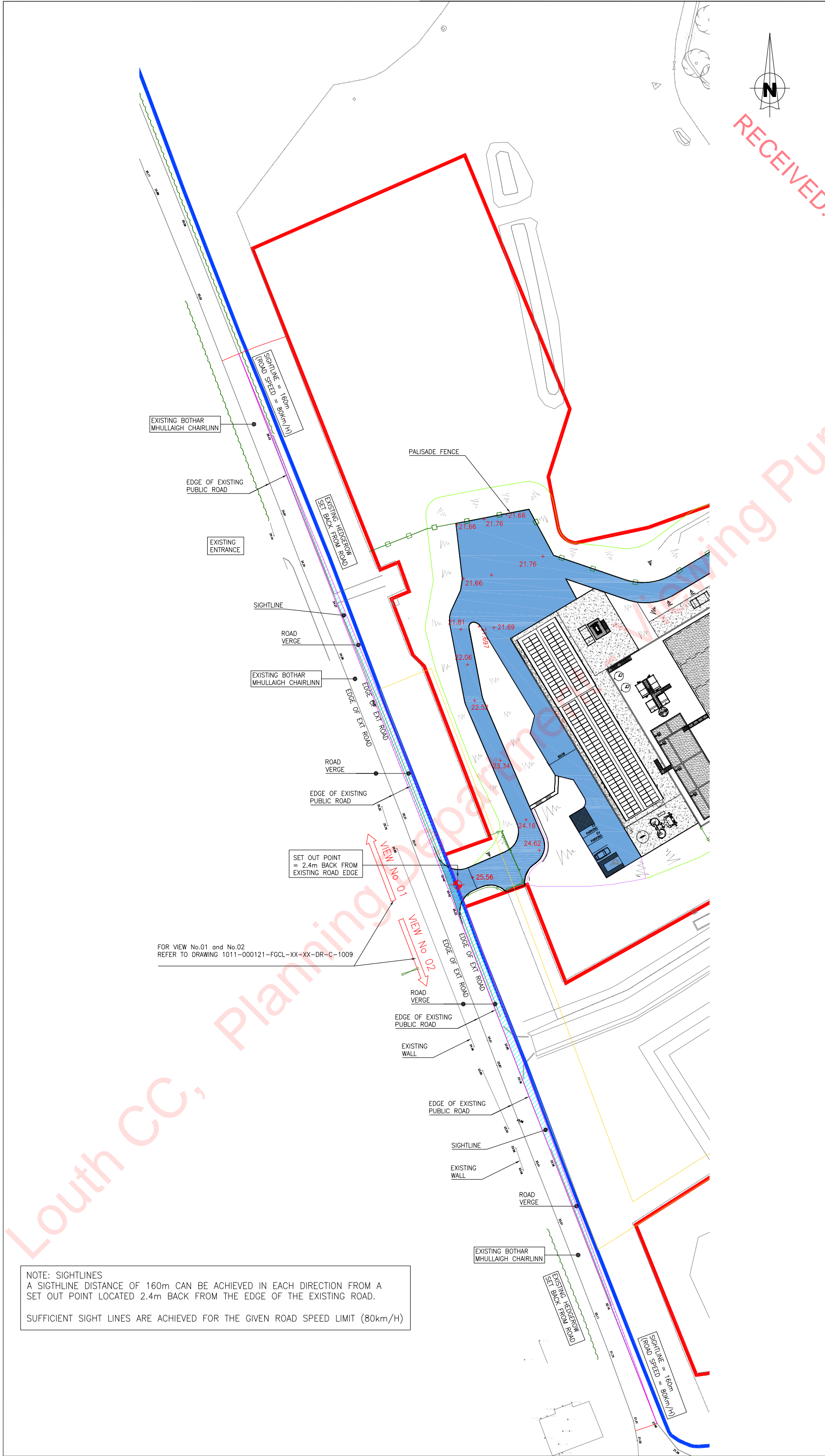

NOTES

1. DO NOT SCALE IF IN DOUBT ASK.

2. LEVELS RELATE TO MAIN HEAD.

3. ALL DIMENSION TO BE VERIFIED ON SITE BY CONTRACTOR.

4. ALL WORK ON THE SITE TO BE IN ACCORDANCE WITH THE SAFETY, HEALTH, AND WELFARE AT WORK (CONSTRUCTION) REGULATIONS 2013.

5. ALL DIMENSIONS ARE IN MILLIMETERS

6. ALL LEVELS SHOWN ARE IN M O.D.

7. ALL DRAWINGS ARE TO BE READ IN CONJUNCTION WITH OTHER CIVIL, STRUCTURAL, MECHANICAL, ELECTRICAL, AND FABRICATORS DRAWINGS.

LANDS UNDER THE CONTROL OF THE APPLICANT

BOUNDARY TO WHICH THE APPLICATION RELATES

AREA = 78,867m²/7.886Hectares

+6.84 - PROPOSED LEVELS

ROAD SPECIFICATION

40mm HOT ROLLED ASPHALT SURFACE COURSE

60mm DENSE BITUMEN MACADAM BINDER COURSE

100mm DBM ROAD BASE

OVER A TYPE B GRANULAR MATERIAL TO SERIES 800 AND TYPE 6F2 CAPPING LAYER TO SERIES 600 OF THE TII SPECIFICATION FOR ROADWORKS.

PRECAST KERBS EITHER SIDE OF ROADWAY

CONCRETE SURFACE (EXTERNAL YARD/ PATH)

CONCRETE SURFACE (TANK ROOFS)

SIGHTLINES

READ IN CONJUNCTION WITH

DRAWING 1011-000121-FGCL-XX-XX-DR-C-1009

The details provided will be subject to detailed design and agreed with the Planning Authority in advance of construction, in the event of a grant of permission.

| | | | | | |
|-----|------------|--------------------------------|----|----|----|
| P06 | 30/07/2024 | ISSUED FOR PLANNING PERMISSION | JH | MB | AH |
| REV | DATE | DESCRIPTION | D | C | A |

PLANNING STAGE

COPYRIGHT RESERVED - THIS DRAWING IS NOT TO BE USED FOR A PURPOSE OTHER THAN THAT FOR WHICH IT HAS BEEN ISSUED BY GLAN AGUA LTD. NOR IS IT TO BE COPIED OR REPRODUCED IN ANY MANNER WITHOUT WRITTEN CONSENT.

CLIENT

WuXi Biologics

Global Solution Provider

MULLAGHARLIN,
DUNDALK, CO. LOUTH, IRELAND.
A91 X56F

PROJECT

EFFLUENT BALANCING & RESOURCE RECOVERY SYSTEM PROJECT

Glanua

Glanua Ltd.,
Railway House,
Station Road,
Loughrea,
Co. Galway,
IRELAND

Tel: +353 (0)909 630 301
Fax: +353 (0)909 630 300
e-mail: info@glanagua.com
www.glanagua.com

TITLE

PROPOSED SIGHTLINES SHEET 1

| | | | |
|-------|------------|------------|------------|
| SCALE | DRAWN | CHECKED | APPROVED |
| 1:500 | EO | AH | AH |
| | DATE | DATE | DATE |
| | 10/06/2024 | 10/06/2024 | 10/06/2024 |

| | | |
|----------------------------------|--------|----------|
| DRAWING No. | STATUS | REVISION |
| 1011-000121-FGCL-XX-XX-DR-C-1008 | S2 | P06 |

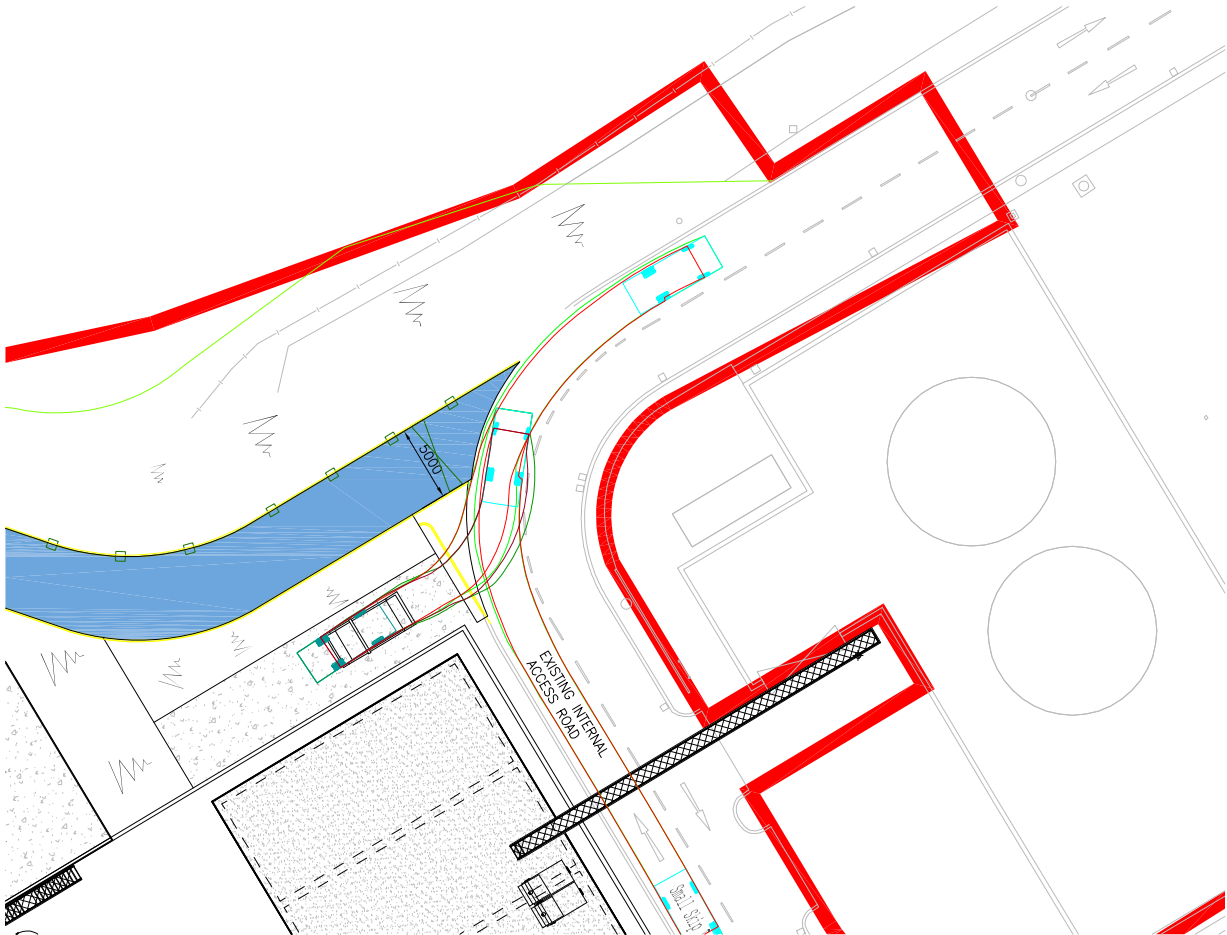

REVERSING SKIP TO
SCREENINGS SKIP
SCALE N.T.S.

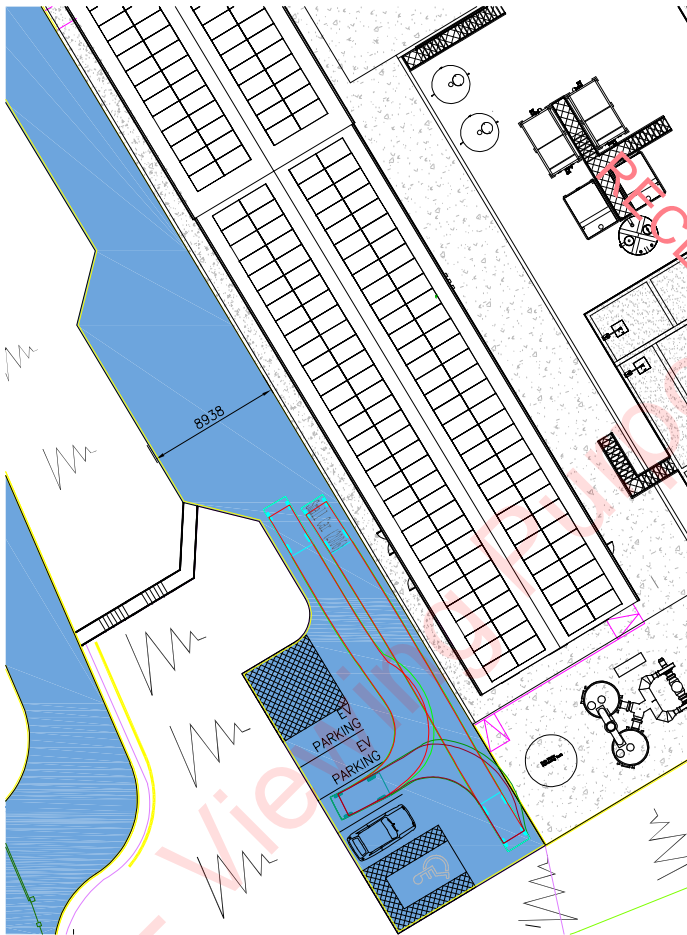

REVERSING CAR INTO PARKING
SPACE & DRIVING OUT
SCALE N.T.S.

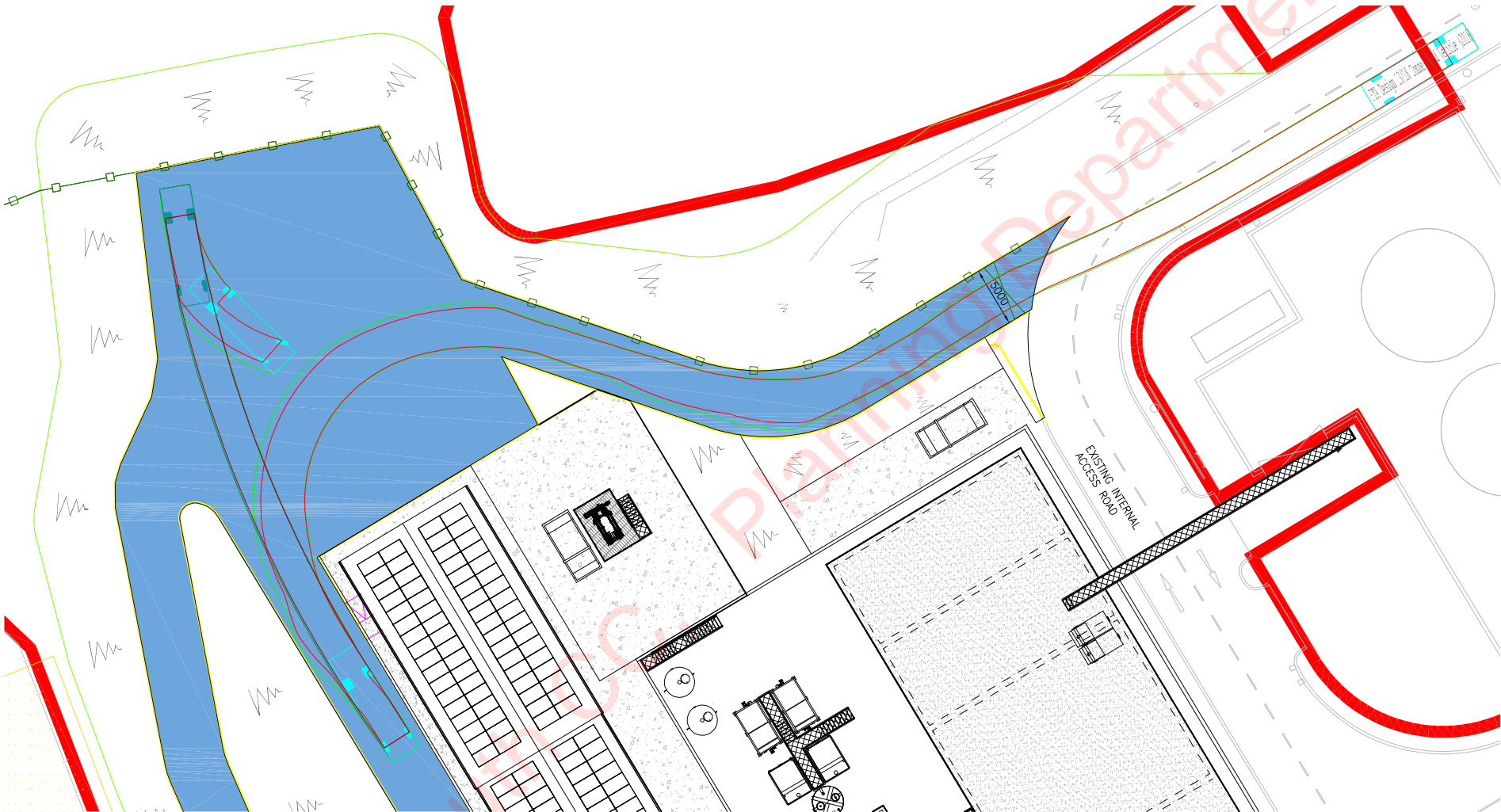

RIGID TRUCK (IN&OUT)
SCALE N.T.S.

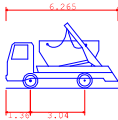

Small Skip Lorry
Overall Length 6.265m
Overall Width 2.04m
Overall Body Height 2.04m
Min Body Ground Clearance 0.09m
Max Track Width 2.04m
Lock-to-lock time 0.09s
Curb to Curb Turning Radius 6.340m



Small Car (2006)
Overall Length 3.626m
Overall Width 1.626m
Overall Body Height 1.626m
Min Body Ground Clearance 0.09m
Max Track Width 1.626m
Lock-to-lock time 0.09s
Curb to Curb Turning Radius 5.330m

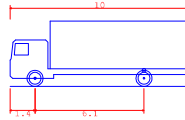

FTA Design 13/18 Tonne Rigid Vehicle (2016)
Overall Length 10.000m
Overall Width 2.550m
Overall Body Height 2.550m
Min Body Ground Clearance 0.09m
Track Width 2.550m
Lock-to-lock time 0.09s
Curb to Curb Turning Radius 11.000m

NOTES

1. DO NOT SCALE IF IN DOUBT ASK.
2. LEVELS RELATE TO MAIN HEAD.
3. ALL DIMENSION TO BE VERIFIED ON SITE BY CONTRACTOR.
4. ALL WORK ON THE SITE TO BE IN ACCORDANCE WITH THE SAFETY, HEALTH, AND WELFARE AT WORK (CONSTRUCTION) REGULATIONS 2013.
5. ALL DIMENSIONS ARE IN MILLIMETERS
6. ALL LEVELS SHOWN ARE IN M O.D.
7. ALL DRAWINGS ARE TO BE READ IN CONJUNCTION WITH OTHER CIVIL, STRUCTURAL, MECHANICAL, ELECTRICAL, AND FABRICATORS DRAWINGS.

LANDS UNDER THE CONTROL OF THE APPLICANT
BOUNDARY TO WHICH THE APPLICATION RELATES
AREA = 78,867m²/17.886Hectares

ROAD SPECIFICATION
40mm HOT ROLLED ASPHALT SURFACE COURSE
60mm DENSE BITUMEN MACADAM BINDER COURSE
100mm DBM ROAD BASE
OVER A TYPE B GRANULAR MATERIAL TO SERIES 800 AND TYPE B2 CAPPING LAYER TO SERIES 600 OF THE T11 SPECIFICATION FOR ROADWORKS.
PRECAST KERBS EITHER SIDE OF ROADWAY

ROAD SPECIFICATION
CONCRETE YARD SLAB

PERMANENT RIGHT OF WAY FOR GAS

The details provided will be subject to detailed design and agreed with the Planning Authority in advance of construction, in the event of a grant of permission.

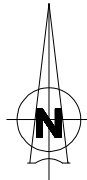

| POS | DATE | ISSUED FOR PLANNING PERMISSION | EO | AH | AH |
|-----|------|--------------------------------|----|----|----|
| REV | DATE | DESCRIPTION | D | C | A |

PLANNING STAGE

COPYRIGHT RESERVED - THIS DRAWING IS NOT TO BE USED FOR A PURPOSE OTHER THAN THAT FOR WHICH IT HAS BEEN ISSUED BY GLAN AGUA LTD. NOR IS IT TO BE COPIED OR REPRODUCED IN ANY MANNER WITHOUT WRITTEN CONSENT.

CLIENT
WuXi Biologics
Global Solution Provider
MULLAGHARLIN,
DUNDALK, CO. LOUTH, IRELAND.
A91 X56F

PROJECT
**EFFLUENT BALANCING &
RESOURCE RECOVERY SYSTEM
PROJECT**

Glanua

Glanua Ltd.,
Railway House,
Station Road,
Loughrea,
Co. Galway,
IRELAND
Tel: +353 (0)909 630 301
Fax: +353 (0)909 630 300
e-mail: info@glanagua.com
www.glanagua.com

TITLE
**PROPOSED AUTOTRACK
SHEET 1**

| SCALE | DRAWN | CHECKED | APPROVED |
|----------------------------------|--------------------------|--------------------------|--------------------------|
| NTS | EO DATE 10/06/2024 | AH DATE 10/06/2024 | AH DATE 10/06/2024 |
| DRAWING No. | STATUS | REVISION | |
| 1011-000121-FGCL-XX-XX-DR-C-1012 | S2 | P05 | |

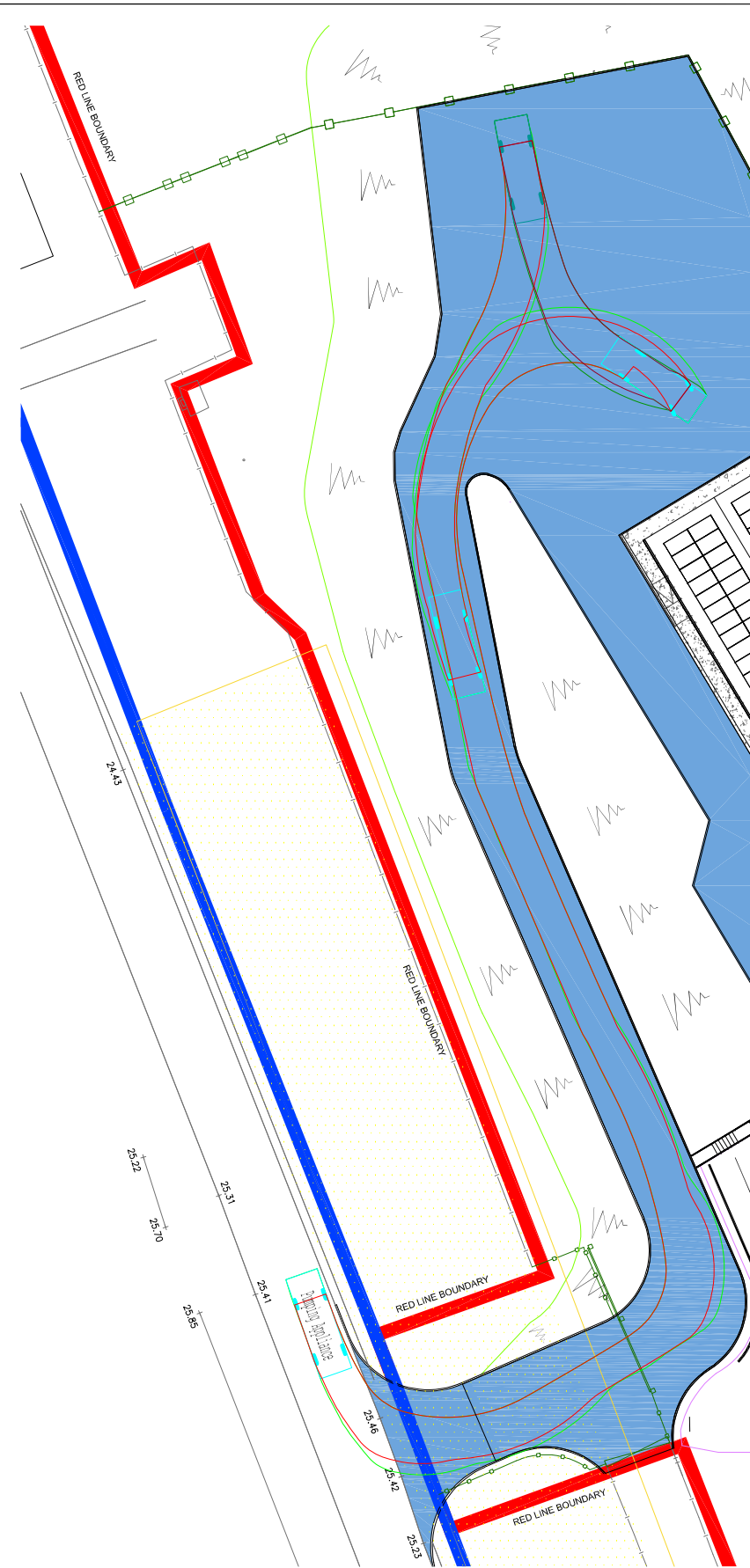

FIRE TENDER MANOEUVRE INTO SITE
SCALE N.T.S.

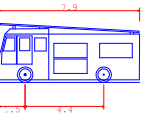

Pumping Appliance
Overall Length 7.900m
Overall Width 4.400m
Overall Body Height 2.500m
Min Body Ground Clearance 1.140m
Track Width 2.500m
Lock to lock time 1.00s
Kerb to Kerb Turning Radius 7.750m

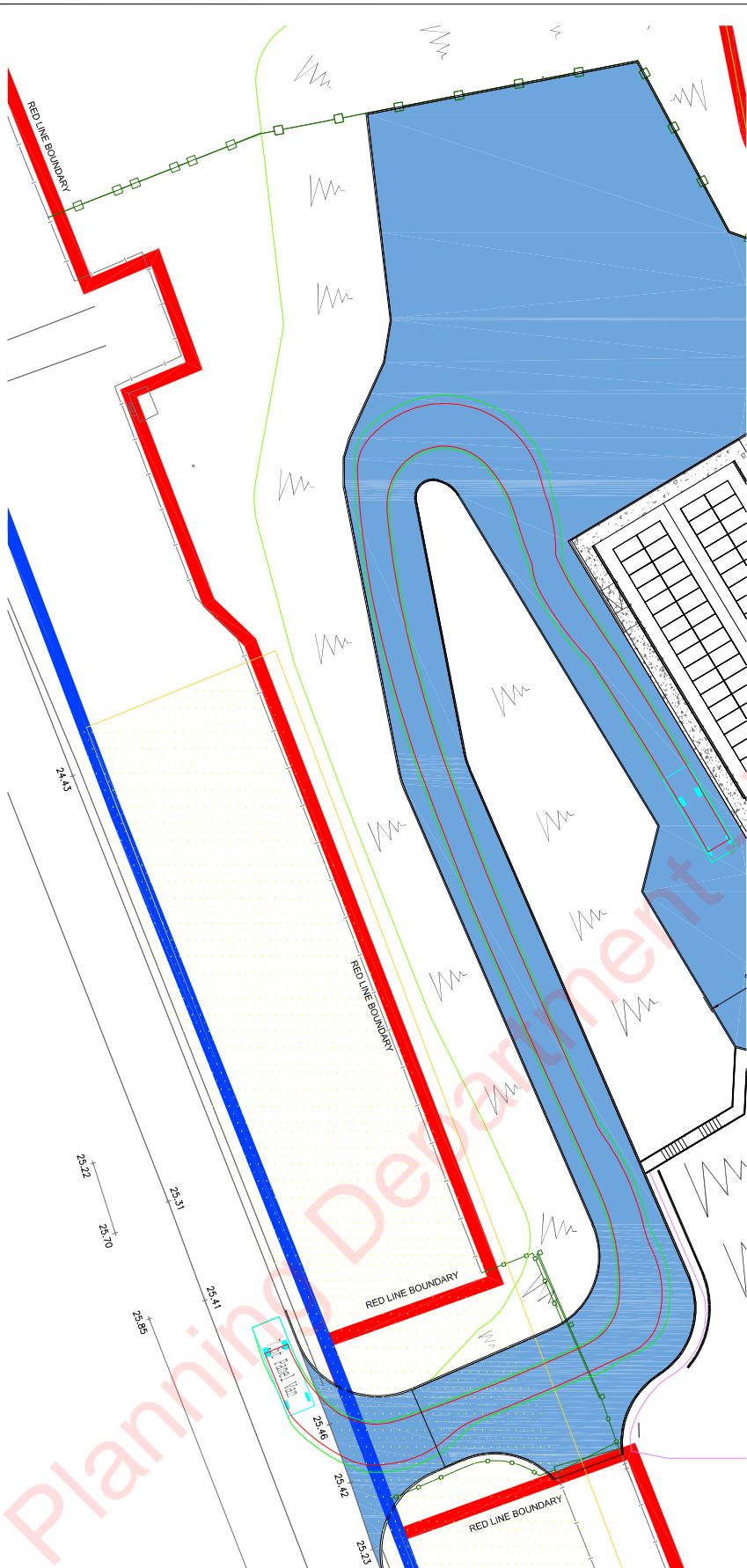

LARGE VAN MANOEUVRE INTO SITE
SCALE N.T.S.

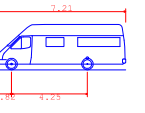

7.5t Panel Van
Overall Length 7.210m
Overall Width 4.250m
Overall Body Height 2.490m
Min Body Ground Clearance 1.140m
Track Width 2.500m
Lock to lock time 1.00s
Kerb to Kerb Turning Radius 7.400m

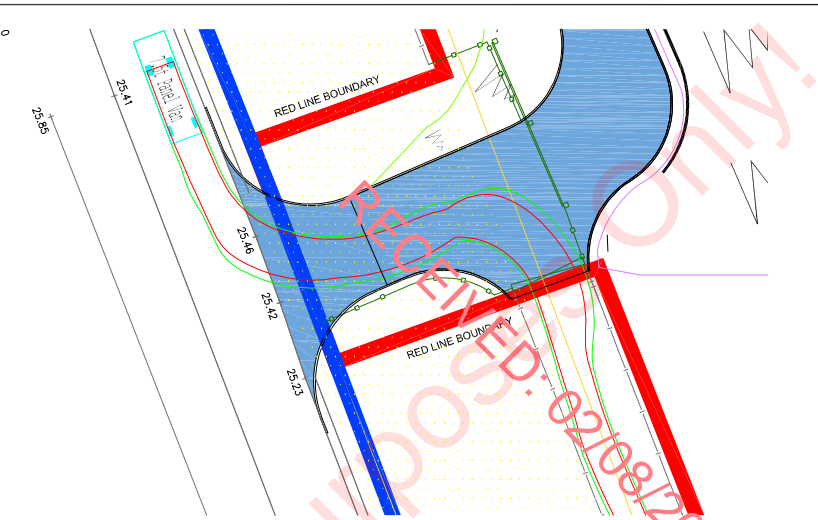

LARGE VAN TO GAS NETWORKS
IRELAND SITE
SCALE N.T.S.

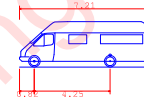

7.5t Panel Van
Overall Length 7.210m
Overall Width 4.250m
Overall Body Height 2.490m
Min Body Ground Clearance 1.140m
Track Width 2.500m
Lock to lock time 1.00s
Kerb to Kerb Turning Radius 7.400m

NOTES

- DO NOT SCALE IF IN DOUBT ASK.
- LEVELS RELATE TO MAIN HEAD.
- ALL DIMENSION TO BE VERIFIED ON SITE BY CONTRACTOR.
- ALL WORK ON THE SITE TO BE IN ACCORDANCE WITH THE SAFETY, HEALTH, AND WELFARE AT WORK (CONSTRUCTION) REGULATIONS 2013.
- ALL DIMENSIONS ARE IN MILLIMETERS
- ALL LEVELS SHOWN ARE IN M O.D.
- ALL DRAWINGS ARE TO BE READ IN CONJUNCTION WITH OTHER CIVIL, STRUCTURAL, MECHANICAL, ELECTRICAL, AND FABRICATORS DRAWINGS.

LANDS UNDER THE CONTROL OF THE APPLICANT

BOUNDARY TO WHICH THE APPLICATION RELATES

AREA = 78,867m²/7.886Hectares

ROAD SPECIFICATION

40mm HOT ROLLED ASPHALT SURFACE COURSE

60mm DENSE BITUMEN MACADAM BINDER COURSE

100mm DBM ROAD BASE

OVER A TYPE B GRANULAR MATERIAL TO SERIES 800 AND TYPE 6F2 CAPPING LAYER TO SERIES 600 OF THE TII SPECIFICATION FOR ROADWORKS.

PRECAST KERBS EITHER SIDE OF ROADWAY

ROAD SPECIFICATION

CONCRETE YARD SLAB

PERMANENT RIGHT OF WAY FOR GAS

The details provided will be subject to detailed design and agreed with the Planning Authority in advance of construction, in the event of a grant of permission.

| | | | | | |
|-----|------------|--------------------------------|----|----|----|
| P06 | 30/07/2024 | ISSUED FOR PLANNING PERMISSION | EO | AH | AH |
| REV | DATE | DESCRIPTION | D | C | A |

PLANNING STAGE

COPYRIGHT RESERVED - THIS DRAWING IS NOT TO BE USED FOR A PURPOSE OTHER THAN THAT FOR WHICH IT HAS BEEN ISSUED BY GLAN AGUA LTD. NOR IS IT TO BE COPIED OR REPRODUCED IN ANY MANNER WITHOUT WRITTEN CONSENT.

CLIENT

WuXi Biologics
Global Solution Provider

MULLAGHARLIN,
DUNDALK, CO. LOUTH, IRELAND.
A91 X56F

PROJECT

EFFLUENT BALANCING &
RESOURCE RECOVERY SYSTEM
PROJECT

Glanua

Glanua Ltd.,
Railway House,
Station Road,
Loughrea,
Co. Galway,
IRELAND

Tel: +353 (0)909 630 301
Fax: +353 (0)909 630 300
e-mail: info@glanagua.com
www.glanagua.com

TITLE

PROPOSED AUTOTRACK
SHEET 2

| | | | |
|-------|------------|------------|------------|
| SCALE | DRAWN | CHECKED | APPROVED |
| NTS | EO | AH | AH |
| | DATE | DATE | DATE |
| | 10/06/2024 | 10/06/2024 | 10/06/2024 |

DRAWING No.

1011-000121-FGCL-XX-XX-DR-C-1013

STATUS

S2

REVISION

P06

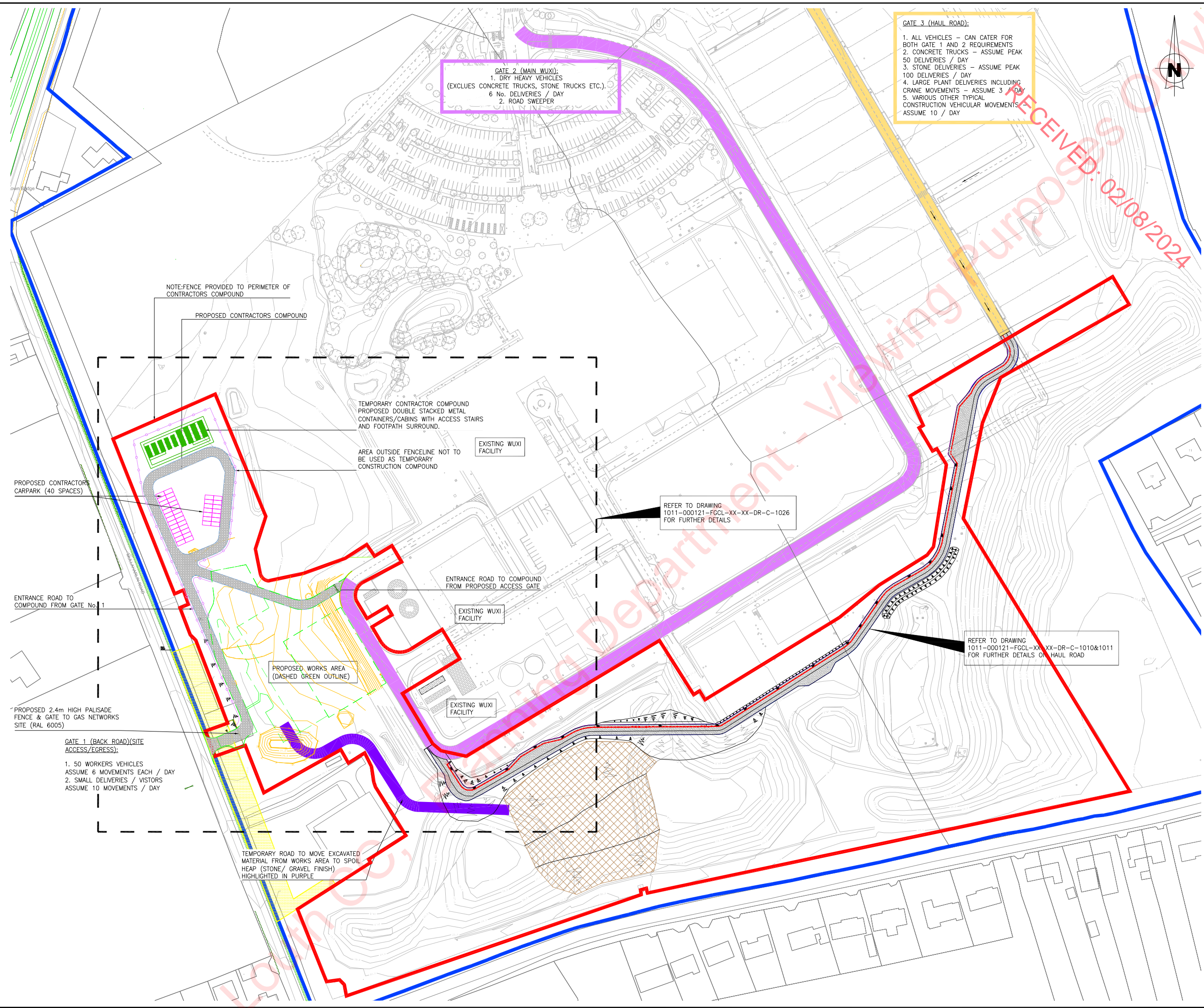

- NOTES
1. DO NOT SCALE IF IN DOUBT ASK.
 2. LEVELS RELATE TO MAIN HEAD.
 3. ALL DIMENSION TO BE VERIFIED ON SITE BY CONTRACTOR.
 4. ALL WORK ON THE SITE TO BE IN ACCORDANCE WITH THE SAFETY, HEALTH, AND WELFARE AT WORK (CONSTRUCTION) REGULATIONS 2013.
 5. ALL DIMENSIONS ARE IN MILLIMETERS
 6. ALL LEVELS SHOWN ARE IN M O.D.
 7. ALL DRAWINGS ARE TO BE READ IN CONJUNCTION WITH OTHER CIVIL, STRUCTURAL, MECHANICAL, ELECTRICAL, AND FABRICATORS DRAWINGS.
- The details provided will be subject to detailed design and agreed with the Planning Authority in advance of construction, in the event of a grant of permission.

- LANDS UNDER THE CONTROL OF THE APPLICANT
- BOUNDARY TO WHICH THE APPLICATION RELATES
AREA = 78,867m²/17.886Hectares
- TEMPORARY ENTRANCE ROAD TO COMPOUND
(STONE/ GRAVEL FINISH)
- TEMPORARY ROAD TO MOVE EXCAVATED MATERIAL
FROM WORKS AREA TO SPOIL HEAP (STONE/
GRAVEL FINISH)
- LAYDOWN & OFFLOADING AREA
- DOUBLE STACKED CABINS/CONTAINER AREA
- AREA FOR SKIPS/PLANT LAYDOWN
- NEW SPOIL HEAP FORMED FROM EXCAVATED
MATERIAL FROM PROPOSED WORKS (ROUGH
PASTURE FINISH WITH WILDFLOWER SEEDING)
- 6m WIDE TEMPORARY HAUL ROAD (INCLUDING 1.2m
PATH) FOR CONSTRUCTION ACCESS
50mm QUARRY SCREENINGS ON
150mm SR21 MATERIAL ON
6F2 CAPPING LAYER -
ALLOW PROVISIONAL OF 250mm
LAYER OF 6F2
- TEMPORARY POWER GENERATOR (CONSTRUCTION
PHASE)
- PERMANENT RIGHT OF WAY FOR GAS
- DEMOLITION / BULK EXCAVATION
- OUTLINE OF PROPOSED WORKS (FOR REFERENCE
ONLY)

| | | | | | |
|-----|------------|--------------------------------|----|----|----|
| P06 | 10/06/2024 | ISSUED FOR PLANNING PERMISSION | EO | AH | AH |
| REV | DATE | DESCRIPTION | D | C | A |

PLANNING STAGE

COPYRIGHT RESERVED - THIS DRAWING IS NOT TO BE USED FOR A PURPOSE OTHER THAN THAT FOR WHICH IT HAS BEEN ISSUED BY GLAN AGUA LTD. NOR IS IT TO BE COPIED OR REPRODUCED IN ANY MANNER WITHOUT WRITTEN CONSENT.

CLIENT

WuXi Biologics
Global Solution Provider

MULLAGHARLIN,
DUNDALK, CO. LOUTH, IRELAND.
A91 X56F

PROJECT

**EFFLUENT BALANCING &
RESOURCE RECOVERY SYSTEM
PROJECT**

Glanua

Glanua Ltd.,
Railway House,
Station Road,
Loughrea,
Co. Galway,
IRELAND

Tel: +353 (0)909 630 301
Fax: +353 (0)909 630 300
e-mail: info@glanagua.com
www.glanagua.com

TITLE

**SITE LAYOUT PLAN FOR
TEMPORARY SITE FENCING
AND COMPOUND**

| | | | |
|----------------------------------|--------------------|--------------------|--------------------|
| SCALE | DRAWN EO | CHECKED AH | APPROVED AH |
| 1:1000 | DATE 10/06/2024 | DATE 10/06/2024 | DATE 10/06/2024 |
| DRAWING No. | STATUS | | REVISION |
| 1011-000121-FGCL-XX-XX-DR-C-1025 | S2 | | P06 |

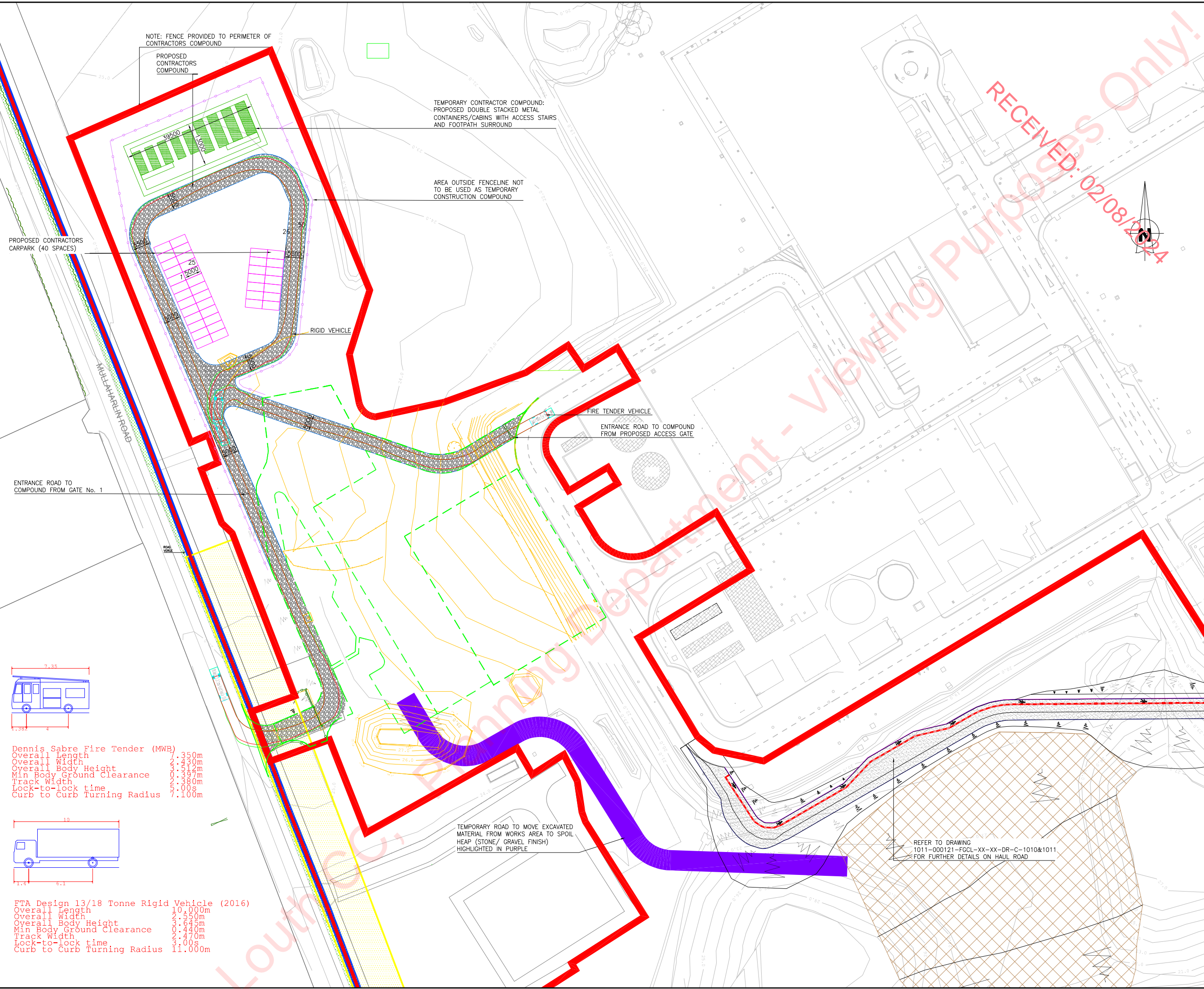

NOTES:

- DO NOT SCALE IF IN DOUBT ASK.
- LEVELS RELATE TO MAIN HEAD.
- ALL DIMENSION TO BE VERIFIED ON SITE BY CONTRACTOR.
- ALL WORK ON THE SITE TO BE IN ACCORDANCE WITH THE SAFETY, HEALTH, AND WELFARE AT WORK (CONSTRUCTION) REGULATIONS 2013.
- ALL DIMENSIONS ARE IN MILLIMETERS
- ALL LEVELS SHOWN ARE IN M O.D.
- ALL DRAWINGS ARE TO BE READ IN CONJUNCTION WITH OTHER CIVIL, STRUCTURAL, MECHANICAL, ELECTRICAL, AND FABRICATORS DRAWINGS.

LANDS UNDER THE CONTROL OF THE APPLICANT

BOUNDARY TO WHICH THE APPLICATION RELATES
AREA = 78.867m²/7.886Hectares

TEMPORARY ENTRANCE ROAD TO COMPOUND
(STONE/ GRAVEL FINISH)

TEMPORARY ROAD TO MOVE EXCAVATED MATERIAL FROM WORKS AREA TO SPOIL HEAP (STONE/ GRAVEL FINISH)

DOUBLE STACKED CABINS/CONTAINER AREA

AREA FOR SKIPS/PLANT LAYDOWN

NEW SPOIL HEAP FORMED FROM EXCAVATED MATERIAL FROM PROPOSED WORKS (ROUGH PASTURE FINISH WITH WILDFLOWER SEEDING)

6m WIDE TEMPORARY HAUL ROAD (INCLUDING 1.2m PATH) FOR CONSTRUCTION ACCESS
50mm QUARRY SCREENINGS ON
150mm SR21 MATERIAL ON
6F2 CAPPING LAYER -
ALLOW PROVISIONAL OF 250mm LAYER OF 6F2

PERMANENT RIGHT OF WAY FOR GAS

DEMOLITION / BULK EXCAVATION

OUTLINE OF PROPOSED WORKS (FOR REFERENCE ONLY)

The details provided will be subject to detailed design and agreed with the Planning Authority in advance of construction, in the event of a grant of permission.

| P06 | 10/06/2024 | ISSUED FOR PLANNING PERMISSION | EO | AH | AH |
|-----|------------|--------------------------------|----|----|----|
| REV | DATE | DESCRIPTION | D | C | A |

DESIGN STAGE

COPYRIGHT RESERVED - THIS DRAWING IS NOT TO BE USED FOR A PURPOSE OTHER THAN THAT FOR WHICH IT HAS BEEN ISSUED BY GLAN AGUA LTD. NOR IS IT TO BE COPIED OR REPRODUCED IN ANY MANNER WITHOUT WRITTEN CONSENT.

CLIENT

WuXi Biologics
Global Solution Provider

MULLAGHARLIN,
DUNDALK, CO. LOUTH, IRELAND.
A91 X56F

PROJECT

EFFLUENT BALANCING &
RESOURCE RECOVERY SYSTEM
PROJECT

Glanua

Glanua Ltd.,
Railway House,
Station Road,
Loughrea,
Co. Galway,
IRELAND

Tel: +353 (0)909 630 301
Fax: +353 (0)909 630 300
e-mail: info@glanagua.com
www.glanagua.com

TITLE

PROPOSED CONTRACTOR SITE
ESTABLISHMENT AND
CONSTRUCTION MANAGEMENT
PLAN

| SCALE | DRAWN | CHECKED | APPROVED |
|----------------------------------|--------------------------|--------------------------|--------------------------|
| 1:500 | EO DATE 10/06/2024 | AH DATE 10/06/2024 | AH DATE 10/06/2024 |
| DRAWING No. | STATUS | | REVISION |
| 1011-000121-FGCL-XX-XX-DR-C-1026 | S2 | | P06 |